

# Conference Program

August 2-4, 2016  
Okinawa, Japan

APICENS

Asia-Pacific International Congress on Engineering &  
Natural Sciences

IBCELC

International Biotechnology, Chemical Engineering  
and Life Science Conference

ISBSS

International Symposium on Business and Social  
Sciences

ISLLE

International Symposium on Language, Linguistics,  
Literature and Education

**APICENS**

**Asia-Pacific International Congress on Engineering & Natural Sciences**

---

ISBN 978-986-89298-2-1

**IBCELC**

**International Biotechnology, Chemical Engineering and Life Science Conference**

---

ISBN 978-986-90263-9-0

**ISBSS**

**International Symposium on Business and Social Sciences**

---

ISBN 978-986-87417-9-9

**ISLLE**

**International Symposium on Language, Linguistics, Literature and Education**

---

ISBN 978-986-89844-7-9

## Content

---

General Information for Participants .....	3
International Committees.....	5
International Committee of APICENS.....	5
International Committee of IBCELC.....	7
International Committee of ISBSS.....	8
International Committee of ISLLE.....	10
Special Thanks to Session Chairs.....	11
Conference Venue Information .....	12
Conference Schedule.....	13
Nature Sciences Keynote Speech .....	16
Social Sciences Keynote Speech .....	18
Oral Sessions.....	19
Biomedical Engineering / Biotechnology Engineering.....	19
Language (1) .....	21
Education (1) .....	23
Education (2) .....	24
Life Science / Natural Science .....	25
Communication / Sociology / Politics / Psychology .....	27
Literature / Linguistics (1) .....	28
Mechanical Engineering/ Civil Engineering / Chemical Engineering.....	29
Education (3) / Linguistics (2) / Language (2) .....	31
Material Science and Engineering.....	33
Finance.....	35
Electrical and Electronic Engineering.....	36
Management.....	37
Business.....	39
Poster Session (1) .....	40
Biomedical Engineering / Biotechnology Engineering / Chemical Engineering / Life Science.....	40
Poster Session (2) .....	45
Civil Engineering / Computer and Information Sciences / Electrical and Electronic Engineering / Material Science and Engineering / Business / Economics / Finance / Management.....	45
Poster Session (3) .....	49
Communication / Education / Sociology / Psychology / Politics .....	49

## ***General Information for Participants***

---

### ■ **Registration**

The registration desk will be situated on the **3<sup>rd</sup> floor** at the **Loisir Hotel Naha** during the following time:

**08:30-17:30 Wednesday, August 3, 2016**

**08:30-17:00 Thursday, August 4, 2016**

### ■ **A Polite Request to All Participants**

Participants are requested to arrive in a timely fashion for all addresses. Presenters are reminded that the time slots should be divided fairly and equally by the number of presentations, and that they should not overrun. The session chair is asked to assume this timekeeping role and to summarize key issues in each topic.



Sandals or Slippers



Tank Top



Shorts

### ■ **Certificate**

#### **Certificate of Presentation or Certificate of Attendance**

A certificate of attendance includes participant's name and affiliation, certifying the participation in the conference. A certificate of presentation indicates a presenter's name, affiliation and the paper title that is presented in the scheduled session.

#### **Certificate Distribution**

Oral presenters will receive a certificate of presentation from the session chair after their presentations or at the end of the session. Poster presenters will receive a certificate of presentation from the conference staff at the end of their poster session.

The certificate of presentation will not be issued, either at or after the conference, to authors whose papers are registered but not presented. Instead, the certificate of attendance will be provided after the conference.

## ■ Preparation for Oral Presentations

All presentation rooms are equipped with a screen, an LCD projector, and a laptop computer installed with Microsoft PowerPoint. You will be able to insert your USB flash drive into the computer and double check your file in PowerPoint. We recommend you to bring two copies of the file in case that one fails. You may also connect your own laptop to the provided projector; however please ensure you have the requisite connector.

## Preparation for Poster Presentation

### Materials Provided by the Conference Organizer:

1. X-frame display & base fabric canvases (60cm×160cm)
2. Adhesive tapes or binder clips

### Materials Prepared by the Presenters:

3. Home-made poster(s)
4. Material: not limited, can be posted on the canvases
5. Recommended poster size: 60cm\*160cm



<p>A 60cm*160cm poster illustrates the research findings.</p>	<ol style="list-style-type: none"> <li>1. Wider than 60cm (left)</li> <li>2. Copy of PowerPoint slides in A4 papers (right)</li> </ol>

# International Committees

---

## International Committee of APICENS

S. Ahmed John, Jamal Mohamed College, India  
Ashley Love, A.T. Still University, USA  
Asmida Ismail, University Technology Mara, Malaysia  
Thippayarat Chahomchuen, Kasetsart University, Thailand  
Don Liu, Louisiana University, USA  
Bayani U. Almacen, Philippine Association of Maritime Training Centers, Philippines  
Jian-Hong Chen, Chung Shan Medical University, Taiwan  
Onder Turan, Anadolu University, Turkey  
Hairul Azman Roslan, Universiti Malaysia Sarawak, Malaysia  
Hiroschi Uechi, Osaka Gakuin University, Japan  
Wong Hai Ming, The University of Hong Kong, Hong Kong  
Ching-An Peng, University of Idaho, USA  
Chee Fah Wong, Universiti Pendidikan Sultan Idris, MALAYSIA  
Christoph Lindenberger, Friedrich - Alexander University, Germany  
Chia-Ray Lin, Academia Sinica, Taiwan  
Fatchiyah M.Kes., Universitas Brawijaya, Indonesia  
Kuan-Chen Cheng, National Taiwan University, Taiwan  
Rainer Buchholz, Friedrich-Alexander University, Germany  
Hamed M El-Shora, Mansoura University, Egypt  
Sittisak Uparivong, Khon Kaen University, Thailand  
Asif Mahmood, King Saud University, Riyadh, Saudi Arabia  
Saji Baby, Kuwait University, KUWAIT  
Shen-Long Tsai, National Taiwan University of Science and Technology, Taiwan  
Suresh B. Gholve, Nagpur University, India  
M. Chandra Sekhar, National Institute of Technology, India  
Chee-Ming Chan, Universiti Tun Hussein Onn Malaysia, Malaysia  
Chi-Ming Lai, National Cheng-Kung University, Taiwan  
Edward J. Smaglik, Northern Arizona University, USA  
Ransinchung R.N.(Ranjan), Indian Institute of Technology, India  
Hasmawi Bin Khalid, University Teknologi Mara, Malaysia  
Roslan Zainal Abidin, Infrastructure University Kuala Lumpur, Malaysia  
Baolin Wang, University of Western Sydney, Australia  
Hung-Yuan Chung, National Central University, Taiwan  
Phongsak Phakamach, North Eastern University, Thailand

Chang Ping-Chuan, Kun Shan University, Taiwan  
P.Sanjeevikumar, University of Bologna, India  
Alexander M. Korsunsky, Trinity College, Oxford, UK  
Michiko Miyamoto, Akita Prefectural University, Japan  
Cheuk-Ming Mak, The Hong Kong Polytechnic University, Hong Kong  
Lai Mun Kou, SEDI University, Malaysia  
William L. Baker, Indiana State University, USA  
Anthony D. Johnson, Seoul National University of Science & Technology, UK  
Chil Chyuan Kuo, Ming Chi University, Taiwan  
Sudhir C.V., Caledonian College of Engineering, Oman  
Abhishek Shukla, R.D. Engineering College Technical Campus, Ghaziabad, India  
Ahmad Zahedi, James Cook University, Australia  
Jeril Kuriakose, Manipal University, India  
Hanmin Jung , Korea Institute of Science and Technology Information (KISTI) , Korea  
Jivika Govil, Zion Bancorporation , India  
Hyoungseop Kim, Kyushu Insititute of Techonogy, Japan  
Farhad Memarzadeh, National Institutes of Health, USA  
Pei-Jeng Kuo, National Chengchi University, Taiwan  
Abdelmalik Serbout, University of physical and sports activities Djelfa Algeria, Algeria

## **International Committee of IBCELC**

Ching-An Peng, University of Idaho, USA

Chee Fah Wong, Universiti Pendidikan Sultan Idris, Malaysia

Christoph Lindenberger, Friedrich-Alexander University , Germany

Chia-Ray Lin, Academia Sinica, Taiwan

Fatchiyah M.Kes., Universitas Brawijaya, Indonesia

Kuan-Chen Cheng, National Taiwan University, Taiwan

Rainer Buchholz, Friedrich-Alexander University, Germany

Hamed M El-Shora, Mansoura University, Egypt

Sittisak Uparivong, Khon Kaen University, Thailand

Asif Mahmood, King Saud University, Riyadh, Saudi Arabia

Saji Baby, Kuwait University, Kuwait

Shen-Long Tsai, National Taiwan University of Science and Technology, Taiwan

Suresh B. Gholve, Nagpur University, India



## **International Committee of ISBSS**

Brian Hunt, Mahidol University , Thailand  
Cheng-Min Feng, National Chiao Tung University, Taiwan  
Donald L. Amoroso, Auburn University at Montgomery, USA  
David Yoon, Universitaire Léonard de Vinci, France  
Maria Cristina M. De los Santos, Kyungdong University-Global Campus, South Korea  
T.S.Devaraja, University of Mysore, Hemagangothri Campus, India  
Amol Gore, Università degli Studi di Padova, Thailand  
Badar Alam Iqbal Aligarh Muslim University, India  
Edward Hwang, Chung Hua University, Taiwan  
Irene Guatno Toribio, Philippine Christian University, Philippines  
José G. Vargas-Hernández, Universidad de Guadalajara, México  
Kaedsiri Jaroenwisan, Silpakorn Univesity, Thailand  
Karen Miranda Fernandez, Imus Institute, Phillippines  
Kazuaki Maeda Chubu Univeristy, Japan  
B. Suresh Lal, Kakatiya University, India  
N. S. Ravishankar, Axis Bank, India  
Ramayah Thurasamy, Universiti Sains Malaysia, Malaysia  
Shiney Chib, Datta Meghe Institute of Management Studies, India  
Kim Sangho, Ritsumeikan Asia Pacific University, Japan  
Tan Khay Boon, SIM Global Education, Singapore  
Micheal Kon, Aletheia University, Taiwan  
Aziz Bin Ahmad University Malaysia Terengganu, Malaysia  
Atefeh Ferdosipour, Azad University (East Tehran Branch), Iran  
Azilawati, Nanyang Technological University, Singapore, Singapore  
Bayram Akarsu, Erciyes University, Turkey  
Bor-Tyng Wang, Feng Chia University, Taiwan  
Donghun Lee, Sungkyunkwan University, South Korea  
Cathine G. Scott, Morris College in Sumter, USA  
Prasong Tanpichai, Kasetsart University, Thailand  
Hamzeh Dodeen, United Arab Emirates University, UAE  
Sadiq Abdulwahed Ahmed Ismail, United Arab Emirates University, UAE  
Kim, Deok Man, Baekseok University, South Korea  
Adeeb Jarrah, United Arab Emirates University, UAE  
Wei-Cheng(Joseph) Mau Wichita State University, USA  
Kanokphon ChantananarungpakSrinakharinwirot University, Thailand  
Vijayaletchumy Subramaniam, Universitas Putra Malaysia, Malaysia  
Linda Oshita, University of Hwaii, USA

Michael Kao, Chang Gung University, Taiwan  
Mingchu (Neal) Luo , Emporia State University, USA  
Theeraphab Phetmalaikul, Srinakharinwirot University, Thailand  
Ricky Yuk-Kwan Ng, Vocational Training Council, Hong Kong, Hong Kong  
Kim , Kyung Hee, Mokpo National University, South Korea  
Shujen Lee Chang, Asia University, Taiwan  
Sally dhruva' Stephenson, Frosterburg State University, USA  
Ching-Yi Tien, I-Shou University, Taiwan  
Reem Abed Almotaleb Abuiyada, Dhofar University, Palestine  
David C. Donald, The Chinese University of Hong Kong, UK  
Rotaru Ioan-Gheorghe, Timotheus Brethren Theological Insititute of Bucharest, Romania  
Obydullah Al Marjuk Independent University, Bangladesh Bangladesh  
Gajendra Singh, Satyawati College, University of Delhi India  
Shaik. Feroz Caledonian College of Engineering, Oman  
Intan Soliha Binti Ibrahim Universiti Malaysia Sabah, Malaysia  
Jamie Halsall University of Huddersfield, UK  
John Christian S. Jardin Palawan State University, Philippines  
Dharam Vir Mahajan, CCS University, Meerut, India  
Darshan kaur Narang, University of Rajasthan, Jaipur, India  
Ronald Griffin, Florida Agricultural & Mechanical University, USA

## **International Committee of ISLLE**

Aziz Bin Ahmad, University Malaysia Terengganu Malaysia  
Atefeh Ferdosipour, Azad University (East Tehran Branch), Iran  
Azilawati, Nanyang Technological University, Singapore  
Bayram Akarsu, Erciyes University, Turkey  
Bor-Tyng Wang, Feng Chia University, Taiwan  
Donghun Lee , Sungkyunkwan University, South Korea  
Cathine G. Scott, Morris College in Sumter, USA  
Prasong Tanpichai, Kasetsart University, Thailand  
Hamzeh Dodeen, United Arab Emirates University, UAE  
Sadiq Abdulwahed Ahmed Ismail , United Arab Emirates University, UAE  
Kim, Deok Man, Baekseok University, South Korea  
Adeeb Jarrah , United Arab Emirates University, UAE  
Wei-Cheng(Joseph) Mau , Wichita State University, USA  
Kanokphon Chantananurpak , Srinakharinwirot University, Thailand  
Vijayaletchumy Subramaniam , Universitas Putra Malaysia, Malaysia  
Linda Oshita , University of Hawaii, USA  
Michael KaoChang , Gung University, Taiwan  
Mingchu (Neal) Luo, Emporia State University, USA  
Theeraphab Phetmalaikul , Srinakharinwirot University, Thailand  
Ricky Yuk-Kwan Ng , Vocational Training Council, Hong Kong  
Kim, Kyung Hee , Mokpo National University, South Korea  
Shujen Lee Chang , Asia University, Taiwan  
Sally dhruva' Stephenson , Frosterburg State University, USA  
Ching-Yi Tien, I-Shou University, Taiwan

## *Special Thanks to Session Chairs*

---

Shu-Ping Lin	National Chung Hsing University
Andrea Nolan	Deakin University
Nobuhiko Takada	Kanazawa Gakuin University
Charles Bingham	Simon Fraser University
Takashi Kamada	University of Malaysia Sabah
Momoyo K. Shibuya	Saitama University
Nadir Baloglan Oglu Memmedli	National Academy of Sciences of Azerbaijan
Tomohiro Nakano	Tokai University
Tomoyasu Akiyama	Bunkyo University
Yoshitake Nishi	Tokai University
Darius Chan	The Chinese University of Hong Kong
Hung-Yuan Chung	National Central University
Peng-Ting Chen	National Cheng Kung University
Chia-Hui Huang	National Taipei University of Business

## Conference Venue Information

Loisir Hotel Naha

ロワジールホテル 那覇

[www.loisir-naha.com](http://www.loisir-naha.com)

〒900-0036 沖縄県那覇市西 3-2-1

TEL : 098-868-2222 / FAX : 098-860-2000

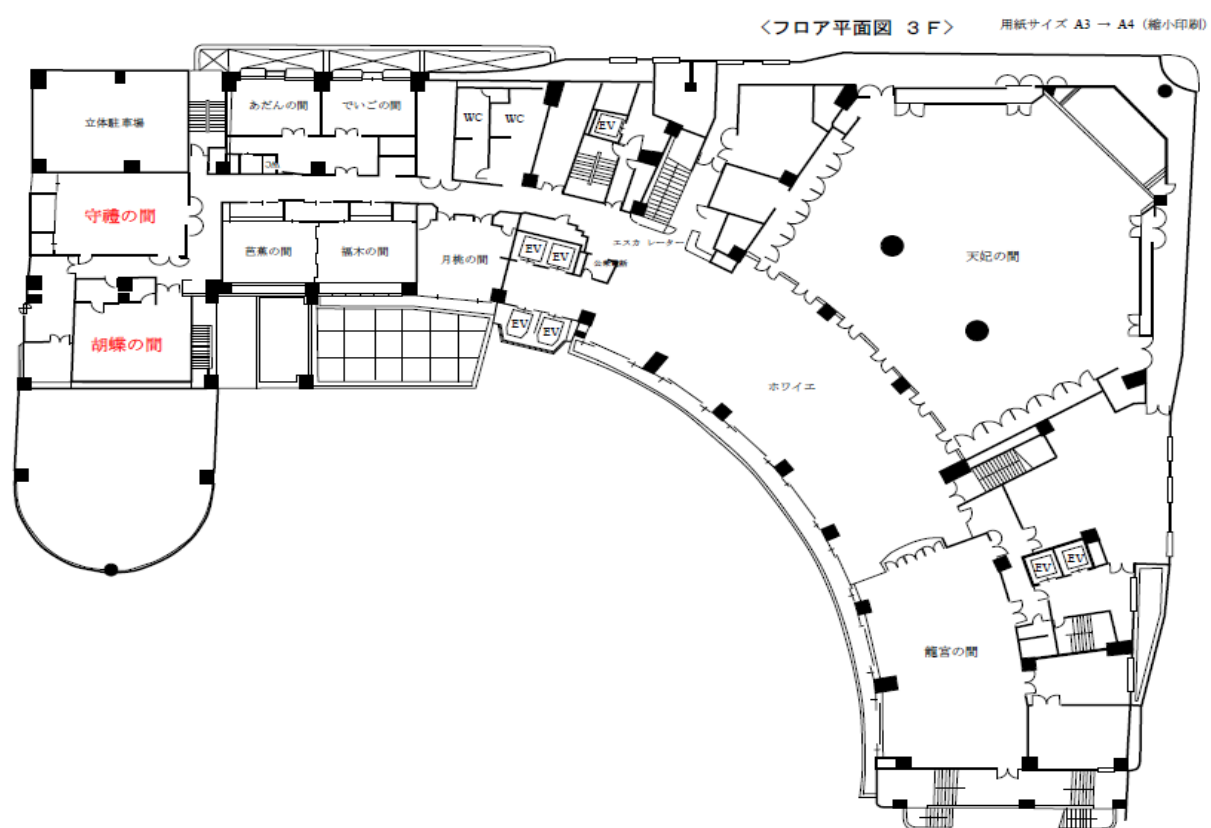

## Conference Schedule

**Tuesday, August 2, 2016**

**Executive Committee Meeting (Executive Committee Only)**

**Wednesday, August 3, 2016**

**Oral Presentation**

**Loisir Hotel Naha (3<sup>rd</sup> Floor)**

Time	Schedule	Venue
<b>08:30-17:00</b>	Registration	Foyer Area
<b>09:00-11:00</b>	Biomedical Engineering / Biotechnology Engineering	守禮の間 (SHUREI no MA)
	Language (1)	胡蝶の間 (KOCHO no MA)
<b>11:00-11:20</b>	<b>Break &amp; Networking</b>	Foyer Area
<b>11:20-12:10</b>	<b><u>Nature Science Keynote Speech</u></b> <b>Dr. Kwun Nam HUI</b> University of Macau <u>Topic: Engineering Spinel Materials for High Energy Density Supercapacitor</u>	守禮の間 (SHUREI no MA)
	<b><u>Social Science Keynote Speech</u></b> <b>Dr. Stacey Vye</b> Saitama University <u>Topic: Creativity, Collaborative Autonomy, and Innovation in Education</u>	胡蝶の間 (KOCHO no MA)
<b>12:00-13:00</b>	<b>Lunch Time</b>	
<b>13:00-14:30</b>	Education (1)	胡蝶の間 (KOCHO no MA)
<b>14:30-14:45</b>	<b>Break &amp; Networking</b>	Foyer Area
<b>14:45-16:15</b>	Education (2)	胡蝶の間 (KOCHO no MA)
<b>16:15-16:30</b>	<b>Break &amp; Networking</b>	Foyer Area
<b>16:30-18:00</b>	Life Science / Natural Science	胡蝶の間 (KOCHO no MA)

**Wednesday, August 3, 2016**

**Poster Presentation**

**Loisir Hotel Naha (3<sup>rd</sup> Floor) 守禮の間 (SHUREI no MA)**

<b>Time</b>	<b>Schedule</b>
<b>13:40-14:40</b>	Poster Sessions (1) Biomedical Engineering / Biotechnology Engineering / Chemical Engineering / Life Science
<b>15:00-16:00</b>	Poster Sessions (2) Civil Engineering / Computer and Information Sciences / Electrical and Electronic Engineering / Material Science and Engineering / Business / Economics / Finance / Management
<b>16:20-17:20</b>	Poster Sessions (3) Communication / Education / Sociology / Psychology / Politics

<b>Thursday, August 4, 2016</b>		
<b>Oral Presentation</b>		
<b>Loisir Hotel Naha (3<sup>rd</sup> Floor)</b>		
<b>Time</b>	<b>Schedule</b>	<b>Venue</b>
<b>08:30-16:30</b>	Registration	Foyer Area
<b>08:45-10:15</b>	Communication / Sociology / Politics / Psychology	守禮の間 (SHUREI no MA)
	Literature / Linguistics (1)	胡蝶の間 (KOCHO no MA)
<b>10:15-10:30</b>	<b>Break &amp; Networking</b>	Foyer Area
<b>10:30-12:00</b>	Mechanical Engineering/ Civil Engineering / Chemical Engineering	守禮の間 (SHUREI no MA)
	Education (3) / Linguistics (2) / Language (2)	胡蝶の間 (KOCHO no MA)
<b>12:00-13:00</b>	<b>Lunch Time</b>	
<b>13:00-14:30</b>	Material Science and Engineering	守禮の間 (SHUREI no MA)
	Finance	胡蝶の間 (KOCHO no MA)
<b>14:30-14:45</b>	<b>Break &amp; Networking</b>	Foyer Area
<b>14:45-16:15</b>	Electrical and Electronic Engineering	守禮の間 (SHUREI no MA)
	Management	胡蝶の間 (KOCHO no MA)
<b>16:15-16:30</b>	<b>Break &amp; Networking</b>	Foyer Area
<b>16:30-17:30</b>	Business	胡蝶の間 (KOCHO no MA)



# Nature Sciences Keynote Speech

守禮の間 (SHUREI no MA), 3<sup>rd</sup> Floor

11:20 - 12:10, Wednesday, August 3, 2016

---

*Topic: Engineering Spinel Materials for High Energy Density Supercapacitor*

**Dr. Kwun Nam HUI**  
Faculty of Science and Technology  
University of Macau  
Avenida da Universidade, Taipa,  
Macau, China



---

## Abstract

The continuous increase in energy demand has significantly stimulated a considerable number of studies for energy storage and conversion applications. Electrochemical capacitors have attracted extensive attention because of their overall advantages of bridging the gap between batteries and conventional capacitors. However, most commercial supercapacitors still suffer from low energy density ( $10 \text{ Wh kg}^{-1}$ ), high cost, and bulky issues in certain consumer products, such as laptops, electronic digital cameras, and mobile phones. Therefore, developing an advanced electrochemical capacitor with advantages of high energy density, lightweight, and low cost while maintaining intrinsic high power density and long cycle life is imperative.

In this talk, the speaker presents his recent work in the development and applications of nanostructured spinel ( $A_xB_3-xO_4$ ) materials for SCs. First, he describes how the synergistic effect of spinel/graphite paper hybrid as high performance binder-free supercapacitor electrode. Second, he illustrates how core-shell nanostructured electrodes can achieve high energy density at high current density as well as high rate capability of for applications in SCs by providing more electroactive sites for electrochemical reactions, facilitating the electrolyte ions access to the surface of active materials, reducing the ions diffusion paths, maintaining the structural integrity of the materials during charge/discharge process, and improving the utilization rate of electrode. Third, he demonstrates the stacking concept as effective method of increasing mass loading of active materials without sacrificing the geometry of the nanostructures for achieving a higher electrochemical performance.

*This work was supported by the Science and Technology Development Fund from Macau SAR (FDCT-098/2015/A3)*

### **Brief Introduction of Dr. Kwun Nam HUI**

Dr. Kwun Nam HUI is an assistant professor at the Institute of Applied Physics and Materials Engineering, Faculty of Science and Technology, University of Macau, Macau SAR, China. He obtained his B.Sc. degree in Physics from the Hong Kong University of Science and Technology in 2003 and his M.Phil. and Ph.D. degrees in Electrical and Electronic Engineering from the University of Hong Kong in 2007 and 2009, respectively. He worked as a postdoctoral associate in 2009 at the Institute of Advanced Materials, Devices, and Nanotechnology, Rutgers, The State University of New Jersey. He contributed to the development of the ultrafast photonic crystal waveguide modulator for communication. He joined Pusan National University in the fall of 2009. Recently, he joined University of Macau in the fall of 2015. Thus far, he has conducted research in different areas related to energy and the environment, including Li-ion battery, supercapacitor, and electrode materials for direct methanol/direct hydrogen peroxide fuel cell, hydrogen production by methanol steam reforming, solid-state lighting, desiccant cooling, removal of volatile organic compounds in air, and wastewater treatment. His major contributions include the use of fluorescent nanospheres for proprietary white-light LEDs, design and implementation of proprietary vertically stacked polychromatic LED structure for color-tunable LEDs, first report of UV-stimulated emission from pivoted GaN-on Si microcavities, first demonstration of UV lasing of GaN nanopillar structure at room temperature, first demonstration of synergetic effects of MnO<sub>2</sub>/graphene composite to improve catalytic ozonation of gaseous toluene, development of reusable catalyst chip for wastewater treatment, green method for synthesizing graphene, metal (oxide)/graphene composite for fuel cell applications, and production of hierarchical N-doped porous carbon from biowastes as electrode materials for supercapacitors. As principal investigator, he has managed 12 research projects with a total research grant of USD 0.8 million. His research has led to one US patent, eleven Korea patents, four review papers, three book chapters, >100 peer-reviewed SCI journal papers, and >50 conference papers. He has served as lead guest editor/guest editor/member of the editorial board of a number of journals, such as Frontier, Reviews in Advanced Sciences and Engineering, Journal of Nanomaterials, Current Nanoscience, The Scientific World Journal, and Scientific Journals International. He was in the organizing committee of the 4th Conference on New Energy and Sustainable Development. His current research focuses on synthesis of hierarchical carbon/graphene materials as well as on the development of 3D hierarchical layered double hydroxide materials as advanced electrode materials for energy storage and conversion applications.

# Social Sciences Keynote Speech

胡蝶の間 (KOCHO no MA), 3<sup>rd</sup> Floor

11:20 - 12:10, Wednesday, August 3, 2016

---

*Topic: Creativity, Collaborative Autonomy, and Innovation in Education*

**Dr. Stacey Vye**

**Associate Professor**

**Center for English Education and Development**

**Saitama University**



---

## **Abstract**

All too often in academia, teacher/researchers can be isolated in their environments because support and faculty development are not readily available. Moreover, in such situations, these teachers/researchers may also experience fear of repercussion if they do not complete large undertakings in a well-timed manner. This feeling of being under continuous pressure leads to a fear of failing, which can undermine the creative force that is essential for innovative learning environments. Therefore, in this workshop, participants will explore ways of developing and sustaining collaborative autonomous support groups where creativity and innovation can flourish for effective change in a variety of academic settings.

## **Brief Introduction of Dr. Stacey Vye**

Stacey Vye is an associate professor at Saitama University at the Center for English Education and Development (CEED) and a lecturer at New York University's School of Continuing and Professional Studies American Language Institute, both in Japan. She also is doctoral candidate at the USC Rossier School of Education in the Organizational Change and Leadership EdD program. Her research interests focus on exploring learner and teacher reflection, and learner and teacher autonomy in language education, including the connections between both capacities.

### Biomedical Engineering / Biotechnology Engineering

Wednesday, August 3, 2016 09:00-11:00

守禮の間

(SHUREI no MA)

Session Chair: *Shu-Ping Lin*

---

#### APICENS-1440

##### The Impact of Uneven Saline Distribution on Thermal Lesion during Radiofrequency Ablation Treatments

Huang-Wen Huang | *Tamkang University*

#### IBCELC-28914

##### Synthesis of Novel Biocompatible Photo-Polymers for 3D Printing

Yu-Chi Su | *National Taiwan University of Science Technology*

Min-Huei Chiou | *National Taiwan University of Science Technology*

Ming-Hua Ho | *National Taiwan University of Science Technology*

#### IBCELC-28920

##### Biocompatible Study of Surface Modification of Anodized Nanostructure on Selective-Laser-Melting Produced Ti6Al4V

Yen-Ting Ou | *National Chung Hsing University*

Chia-Wei Huang | *National Chung Hsing University*

Shu-Ping Lin | *National Chung Hsing University*

#### IBCELC-28923

##### Impedimetric Detection of Dopamine Using Reduced Graphene-Oxide-Based Biosensors

Jhong-Yi Ciou | *National Chung Hsing University*

Tung-Yen Lai | *National Nano Device Laboratories*

Tsung-Wu Lin | *Tung Hai University*

Shu-Ping Lin | *National Chung Hsing University*

**IBCELC-28924**

**Efficient Acetic Acid Production from Nipa Sap by Fed-Batch Fermentation Using *Moorella thermoacetica* (f. *Clostridium thermoaceticum*)**

Dung Van Nguyen | *Kyoto University*

Harifara Rabemanolontsoa | *Kyoto University*

Shiro Saka | *Kyoto University*

**IBCELC-28929**

**Investigation into the Combined Effects of Small Chemical and Nanostructure on Biocompatibility of Titanium and Its Alloy**

Shu-Ping Lin | *National Chung Hsing University*

Yen-Ting Ou | *National Chung Hsing University*

Chia-Wei Huang | *National Chung Hsing University*

**IBCELC-28932**

**In Vitro Three-Dimensional Lymphatic Endothelials Growth for Evaluation of Hyperthermia Effect**

Pei Chien Tseng | *National Chung Hsing University*

Shu-Yen Huang | *National Chung Hsing University*

Shu-Ping Lin | *National Chung Hsing University*

## Language (1)

Wednesday, August 3, 2016 09:00-11:00

胡蝶の間

(KOCHO no MA)

Session Chair: *Andrea Nolan*

---

### ISLLE-1337

#### **Language Acquisition Database: User Interface Needs Analysis**

David Wright | *Tokai University*

Hiroshi Nakagawa | *Tokai University*

### ISLLE-1341

#### **The Profile of Non-Native Teacher's Oral Skills: A Study Carried out in Brasília, the Capital of Brazil**

Joana Grant | *Cooplem Idiomas*

### ISLLE-1329

#### **Digital Editing Studio: The Roles of Multimodal Literacy and Interaction for TEFL University Learners**

Chia-Yi Li | *Southern Taiwan University of Science and Technology*

### ISLLE-1357

#### **Improving EFL Learners' Quasiacademic Presentation Performances through "Cognitive Framed Logic Approach"**

Wen-Pi Chao | *Tamkang University*

### ISLLE-1360

#### **Bilingual Education of Hmong Ethnic (Case Study in Lao Chai Commune, Sapa District, Lao Cai Province, Viet Nam)**

Le Thi Thu | *National Cheng Kung University*

### ISLLE-1361

#### **Research into Dialectal Variation in Vietnamese of Migrant Workers: A Case Study of Dat Cuoc Industrial Zone, Binh Duong Province, Vietnam**

Dang Thi Kieu Oanh | *National Cheng Kung University*

**ISLLE-1330**

**Exploring Teachers Talk during Oral Language Teaching Interactions from Both Sides of the School Fence**

Andrea Nolan | *Deakin University*

Louise Paatsch | *Deakin University*

Janet Scull | *Monash University*

## Education (1)

Wednesday, August 3, 2016 13:00-14:30

胡蝶の間  
(KOCHO no MA)

Session Chair: *Nobuhiko Takada*

---

### ISBSS-6058

#### **How Far Figurative Design Can Go: Defamiliarized Expressions by Operation**

Shih-Hung Cheng | *National Yunlin University of Science and Technology*

Tzu-Ching Hsu | *National Chiao Tung University*

Ming-Huang Lin | *National Chiao Tung University*

### ISBSS-6088

#### **The Expression of the Traditional Craft Article of Ishikawa Prefecture by Projection Mapping**

Issei Yoshida | *Kanazawa Gakuin University*

Nobuhiko Takada | *Kanazawa Gakuin University*

### ISBSS-6095

#### **An Educational Study for Applying Generative Design Using a Computer Mouse Design as an Example**

Lin-Chien Lee | *National Chiao Tung University*

Ming-Huang Lin | *National Chiao Tung University*

### ISBSS-6115

#### **Comparative Study of Tablet and Laptop Devices for Business Game Practice**

Takashi Tachino | *Shoin University*

Jaewook Kim | *Shoin University*

### ISBSS-6947

#### **A Study on Korean English Learners' Amplifier Acquisition**

Jaewon Yang | *Pusan National University*

### ISBSS-6084

#### **An FLES Program that Impacted a Small Island**

Huimei Grace Yang | *National Quemoy University*

Chungju Tim Fan | *National Quemoy University*



## Education (2)

Wednesday, August 3 , 2016 14:45-16:15

胡蝶の間

(KOCHO no MA)

Session Chair: *Charles Bingham*

---

### ISLLE-1348

#### **Teaching Rhetoric Today: Ancient Exercises for Contemporary Citizens**

Julie Dainville | *Université libre de Bruxelles*

Benoît Sans | *Université libre de Bruxelles*

### ISLLE-1332

#### **Learning to Teach through an Indigenous Lens**

Eunice Tang | *The Chinese University of Hong Kong*

Eddy K.W. Li | *University of Cambridge*

### ISLLE-1376

#### **Education as an Art Form**

Charles Bingham | *Simon Fraser University*

### ISLLE-1372

#### **Representation of Ethnic and Religious Minorities in Textbooks: Promotion of Multiculturalism in History Curriculum**

Liz Jackson | *University of Hong Kong*

### ISLLE-1339

#### **Action Research: Engaging Readers**

Grace P. Wilkins | *University of Southern California*

### ISLLE-1386

#### **A Longitudinal Picture of English Enhancement Support in Hong Kong in 2016**

Barley S. Y. Mak | *The Chinese University of Hong Kong*

## Life Science / Natural Science

Wednesday, August 3 , 2016 16:30-18:20

胡蝶の間

(KOCHO no MA)

Session Chair: *Prof. Takashi Kamada*

---

### IBCELC-28907

#### **Deciphering and Manipulating Natural Product Biosynthetic Gene Clusters by Bioinformatics and Functional Recombinations**

Hsien-Tai Chiu | *National Cheng Kung University*

### IBCELC-28913

#### **Novel Anti-Bacterial Halogenated Tricyclic Sesquiterpenes from Bornean *Laurencia majuscula***

Takashi Kamada | *University of Malaysia Sabah*

Chin-Soon Phan | *University of Malaysia Sabah*

Charles Santhanaraju Vairappan | *University of Malaysia Sabah*

### IBCELC-28946

#### **Effects of Photoperiod on Production Performances and Reproductive Development of Female Betong Chicken (*Gallus domesticus*)**

Kruan Buakeeree | *Songkhla Rajabhat University,*

Piyanan Nualhnuplong | *Songkhla Rajabhat University,*

### APICENS-1418

#### **Anti-Bacterial Diterpenes from Bornean Soft Corals *Sinularia flexibilis***

Takashi Kamada | *University of Malaysia Sabah*

Wei-Teng Wong | *University of Malaysia Sabah*

Chin-Soon Phan | *University of Malaysia Sabah*

Charles Santhanaraju Vairappan | *University of Malaysia Sabah*

### APICENS-1449

#### **Pot-Pollen is the Bee Pollen Stored by Meliponini: *Tetragonisca angustula*, Mérida-Venezuela and Sucumbíos-Ecuador**

Patricia Vit | *Universidad de Los Andes*

**APICENS-1413**

**A Crowdsourcing Mobile Game Used for Biomedical Named-Entity Recognition**

Tien-Hao Chang | *National Cheng Kung University*

Yen-Lin Huang | *National Cheng Kung University*

**APICENS-1486**

**A Preliminary Life Cycle Assessment (LCA) of Mango Production in Taiwan**

Geoff M. Nicki | *National Dong Hwa University*

Ming C. Su | *National Dong Hwa University*

Chin H. Chang | Tainan District Agricultural Research and Extension Station, Council of Agriculture

**APICENS-1485**

**Developing a Regional Water Resilience Capacity Index for a Forest Park Catchment in Taiwan**

Ming-Chien Su | *National Dong Hwa University*

Yi-Zih Chen | *National Dong Hwa University*

Nien-Hsin Kao | Kun Shan University

## **Communication / Sociology / Politics / Psychology**

**Thursday, August 4 , 2016**

**08:45-10:15**

守禮の間

**(SHUREI no MA)**

Session Chair: *Momoyo K. Shibuya*

---

### **ISBSS-6060**

#### **An Exploration of Mobile Application Icons Designing in Relation to the Visual Perception of Senior Consumers**

Yi-Lin Yu | *Fu Jen Catholic University*

### **ISBSS-6078**

#### **Use of Facebook in Media Law & Ethics: A Descriptive Study**

Gilbert D. Martinez | *Texas State University*

### **ISBSS-6120**

#### **Media Glorified the Violence Phenomenon - In the Cartoon "Bears Appear" as an Example**

Ning Pan | *Fu Jen Catholic University*

### **ISBSS-6106**

#### **The Electronic Voting Admission Using a Cell Phone and Its Evaluation**

Jaewook Kim | *Shoin University*

Takashi Tachino | *Shoin University*

### **ISBSS-6104**

#### **Analysis about the Relation between Aggression and Many Causes**

Dain Kim | *Paul Math International School*

Daeryong Seo | *Paul Math International School*

### **ISBSS-6980**

#### **Subjective Well-Being and Social Networks in Urban Asia**

Momoyo K. Shibuya | *Saitama University*

## Literature / Linguistics (1)

Thursday, August 4 , 2016

08:45-10:15

胡蝶の間

(KOCHO no MA)

Session Chair: *Nadir Baloglan Oglu Memmedli*

---

### ISLLE-1324

#### **The Word against the Sword: Arabic Poetry in the Face of Despotism**

Salaheldin Abdelaziz Elgebily | *Hankuk University of Foreign Studies*

### ISLLE-1334

#### **“Seven Valleys” in Sheikh Faridaddin Attar’s and Seyid Yahya Bakuvi’s Works**

Nezaket Fatali Memmedli | *Institute of Manuscript*

### ISLLE-1371

#### **When Modern Lifestyle Threaten Urban Society in Nadira by Leila S. Chudori**

Hiqma Nur Agustina | *University of Islamic Syekh Yusuf (UNIS) Tangerang*

### ISLLE-1323

#### **Politics, Language Policies and Language Perceptions in Multilingual Taiwan**

Chin-Hui Chen | *National Pingtung University of Science and Technology*

Chang-Xin Chen | *National Pingtung University of Science and Technology*

Min-Hua Tsai | *National Pingtung University of Science and Technology*

Yen-Yu Yang | *National Pingtung University of Science and Technology*

### ISLLE-1368

#### **Terms of Arabic Origin in Azerbaijani Language, Borrowed From European Languages through Russian**

Nadir Baloglan Oglu Memmedli | *National Academy of Sciences of Azerbaijan*

# Mechanical Engineering/ Civil Engineering / Chemical Engineering (1)

Thursday, August 4 , 2016

10:30-12:15

守禮の間

(SHUREI no MA)

Session Chair: *Prof. Tomohiro Nakano*

---

## **APICENS-1414**

### **Analysis of the Current Density Distribution in Patterned Mask Electrochemical Micro-Machining on the Invar Alloy Sheet: Applied Finite Element Method**

Da-Som Jin | *Inha University*

Kwang-Ho Chun | *Inha University*

Eun-Sang Lee | *Inha University*

## **APICENS-1398**

### **Development of Quaternized Polymer Based Ionomer Binder for On-Site Crosslinking at Energy Conversion Electrodes**

Jin-Soo Park | *Sangmyung University*

Mun-Sik Shin | *Sangmyung University*

Hyoungh Juhn Kim | *Korea Institute of Science and Technology*

## **APICENS-1400**

### **The Effect of Elevation Irregularity on Progressive Collapse Resistance of Multistory Reinforced Concrete Framed Structures under Gravity Loads**

Mohamed El-Bayomy | *Cairo University*

Hamed Salem | *Cairo University*

## **APICENS-1433**

### **Effect of Corrosion on Ductility of RC Columns**

Ahmed Mohammed Youssef Mohammed | *Cairo University*

Ali Ahmed | *The University of Engineering and Technology Lahore*

Koichi Maekawa | *The University of Tokyo*

## **APICENS-1458**

### **Evaluation of Inertial Force Effect of PC Rahmen Bridge under Various Fault Directions**

Tomohiro Nakano | *Tokai University*

**APICENS-1455**

**Comparisons on Thermal Stability of Quasi-Solid Electrolyte Samples Containing LiI for Grätzel-Type Solar Cells by TG and Coupled Methods of Evolved Gas Analysis**

Viola Nagygyörgy | *Budapest University of Technology and Economics and Shizuoka University*

György Pokol | *Budapest University of Technology and Economics*

János Madarász | *Budapest University of Technology and Economics*

Elias Stathatos | *Technological-Educational Institute of Patras*

**APICENS-1476**

**Biomimetic Surface Design and Fabrication for Eco-friendly Energy Saving Applications**

Kijung Yong | *Pohang University of Science and Technology*

**APICENS-1451**

**Design of Smart Walker for Gait and Balance Rehabilitation**

Ahmad Muammar Bin Md Yasin | *Singapore Institute of Technology*

Lim Wei Liong | *Singapore Institute of Technology*

Dr. Patrick S.K.Chua | *Singapore Institute of Technology*

Zheng Jianxin | *Singapore Institute of Technology*

## Education (3) / Linguistics (2) / Language (2)

Thursday, August 4, 2016 10:30-12:00

胡蝶の間

(KOCHO no MA)

Session Chair: *Tomoyasu Akiyama*

---

### ISLLE-1311

#### **Implementing Culturally Responsive Teaching in an Introductory Corpus Linguistics Course**

Apay Ai-Yu Tang | *National Dong Hwa University*

### ISLLE-1344

#### **An Investigation of Rater Variability in the Context of Teacher Employment Examinations Using a Mixed Approach**

Tomoyasu Akiyama | *Bunkyo University*

### ISLLE-1340

#### **Help Depressed College Students to Come out of Closet: Reduce Stigma Perceptions, Enhance Help-Seeking Communication**

Ling-Hui Hsu | *Ming Chuan University*

### ISLLE-1378

#### **Oops, Being Handsome is So Awful! A Cognitive-Affective-Constructional Analysis of the Intensifier ‘can3le5’ in Taiwan Mandarin**

Shumei Chiang | *Aletheia University*

### ISLLE-1327

#### **Court Sight Translation from Text-Linguistic Approach**

Yaling Chen | *Aletheia University*

### ISLLE-1335

#### **We Have a Digital Story to Tell: Low-Achieving English Language Learners Found a Way to Express Themselves**

Hsiao-Chien Lee | *National Kaohsiung Marine University*

Pei-Ling Wang | *National Kaohsiung University of Applied Sciences*



**ISLLE-1365**

**The Effect of Blending Instruction on Different Cognitive Style Students' English  
Listening Comprehension**

Pei-Ling Wang | *National Kaohsiung University of Applied Sciences*

Hsiao-Chien Lee | *National Kaohsiung Marine University*

## Material Science and Engineering / Chemical Engineering (2)

Thursday, August 4 , 2016

13:00-14:30

守禮の間

(SHUREI no MA)

Session Chair: *Prof. Yoshitake Nishi*

---

### APICENS-1429

#### **Remarkable Adhesion Improvement of Ti/Polymer Lamination Joints Irradiated by EB Prior to Hot-Press**

Masataka Tomizawa | *Tokai University*

Michael C. Faudree | *Tokai University*

Arata Yagi | *Tokai University*

Itaru Jimbo | *Tokai University*

Yoshitake Nishi | *Tokai University*

### APICENS-1430

#### **Mechanical Properties of CFRP/Al Lamination Irradiated by Electron Beam Prior to Hot-Pressing**

Daisuke Kitahara | *Tokai University*

Akiko Minegishi | *Tokai University*

Yoshihito Mastumura | *Tokai University*

Yoshitake Nishi | *Tokai University*

### APICENS-1431

#### **Attractive Surface Performances Induced by EB-Irradiation**

Yoshitake Nishi | *Tokai University*

Michael Christopher Faudree | *Tokai University*

Ryuichiro Ohyama | *Tokai University*

Ryo Nomura | *Tokai University*

Anna Takahashi | *Tokai University*

Masae Kanda | *Chubu University*

Noriyuki Inoue | *Chubu University*

**APICENS-1462**

**Development of Multilayer Ceramic Wireless Power Transfer Fabricated by Photo Resist Film Process**

Minami Takato | *Nihon University*

Ken Saito | *Nihon University*

Fumio Uchikoba | *Nihon University*

**IBCELC-28909**

**Synthesis and Properties of Poly(phenylene telluride) Obtained by Condensation Reaction of Tetrachlorotellurium and Triphenylmethane**

Hiroto Kudo | *Kansai University*

Daisuke Inoue | *Kansai University*

**IBCELC-28957**

**Expanding Scalability of Top-Down and Bottom-Up Nanofabrication**

Wooyoung Shim | *Yonsei University*

## Finance

Thursday, August 4 , 2016

13:00-14:30

胡蝶の間

(KOCHO no MA)

Session Chair: *Darius Chan*

---

### ISBSS-5406

#### **Multiple Large Shareholders, Corporate Risk Taking and Share Repurchases in China**

Yi-Pei Chen | *Chung Yuan Christian University*

Tsui-Jung Lin | *Chinese Culture University*

Patumtip Wongsacharoensuk | *Chung Yuan Christian University*

### ISBSS-5455

#### **Mental Accounting and Personal Finance for Savings**

Piyada Sombatwattana | *Srinakharinwirot University*

### ISBSS-6076

#### **The Efficiency of Internal Capital Markets and the Quality of Internal Accounting Information**

Yong Zhang | *Hong Kong Polytechnic University*

### ISBSS-6098

#### **The Impact of Investors' Sentiment on Stock Price - Observations from Financing Strategy of Listed Companies in Taiwan**

Hsin-Jung Hsieh | *Kainan University*

### ISBSS-6108

#### **Stopping Mandatory Financial Forecasts and Analyst Coverage: Evidence from Taiwan**

Wann-Cherng Wang | *National Sun Yat-Sen University*

### ISBSS-6065

#### **Antecedents and Consequences of Acceptance of Wealth Inequality: Findings from a Territory-Wide Phone Survey in Hong Kong**

Darius Chan | *The Chinese University of Hong Kong*

Grand Cheng | *Duke-NUS Graduate Medical School*

Dannii Yeung | *City University of Hong Kong*

## Electrical and Electronic Engineering

Thursday, August 4, 2016 14:45-16:15

守禮の間

(SHUREI no MA)

Session Chair: *Prof. Hung-Yuan Chung*

---

### APICENS-1405

#### **The Potential of Graphene Oxide to Passivate Si Solar Cells**

Chu-Hsuan Lin | *National Dong Hwa University*

Guan-Yu Chen | *National Dong Hwa University*

Cheng-Ya Yu | *Taiwan Solar Energy Corporation*

Liang-Chun Chen | *National Dong Hwa University*

### APICENS-1416

#### **Nonlinear/Non-Gaussian Bayesian Tracking Algorithm Based on Cubature-Based Particle Filter**

Chien-Hao Tseng | *National Chiao Tung University*

Dah-Jing Jwo | *National Taiwan Ocean University*

Sheng-Fuu Lin | *National Chiao Tung University*

### APICENS-1450

#### **The DTC of Permanent Magnet Synchronous Motor in Low Speed Condition Improvement Using Flux Compensator**

Yi-Hao Jhu | *National Central University*

Hung-Yuan Chung | *National Central University*

## Management

Thursday, August 4 , 2016

14:45-16:15

胡蝶の間

(KOCHO no MA)

Session Chair: *Peng-Ting Chen*

---

### ISBSS-5429

#### **The Hospitals' Big Data Implementation Resistance**

Peng-Ting Chen | *National Cheng Kung University*

Ya-Ci Ke | *National Kaohsiung University of Applied Science*

Kuan-Chen Lee | *National Kaohsiung University of Applied Science*

Wan-Ning Wu | *National Sun Yat-sen University*

Chia-Li Lin | *Shih Chien University*

### ISBSS-5436

#### **The Impacts of Product Innovation and Value Chain Position upon Servitization-An Empirical Study from Taiwan CIS Survey**

Bang-Ning Hwang | *National Yunlin University of Science and Technology*

Mu-Yen Hsu | *National Cheng-Chi University*

Tzu-Chi Chang | *National Yunlin University of Science and Technology*

### ISBSS-6043

#### **The Study of Car Selection in German via Grey Relational Grade**

Yi-Chang Shen | *Chienkuo Technology University*

Yun-Chun Wang | *Chienkuo Technology University*

Wei-Chin Hung | *Chienkuo Technology University*

Tzu-Hao Lin | *YunTech*

Mei-Li You | *Chienkuo Technology University*

Kun-Li Wen | *Chienkuo Technology University*

### ISBSS-6080

#### **Organizational Identification, Organizational Commitment and the Employer's Word of Mouth (WOM) Intention**

Luan-Ying Wei | *Takming University of Science and Technology*

Yun-Ying Lee | *Takming University of Science and Technology*

**ISBSS-6103**

**A Study on Establishing Adaptive Solution to Relocated Sites in Daegu, Korea**

Jin Choi | *Chonnam National University*

Woo-Hwa Shin | *Daegu Gyeongbuk Development Institute*

Xiaochen Zhang | *Chonnam National University*

Woo-Jin Shin | *Chonnam National University*

**ISBSS-6989**

**Internal Marketing – A Pretence**

Prakash Vel | *University of Wollongong in Dubai*

Aakash M Shah | *Independent Analyst*

Sunita Mathur | *Independent Market Analyst*

**ISBSS-6102**

**Knowledge Sharing and Knowledge Creation in Enterprise the Viewpoint of “Empirical Knowledge”**

Chengning Yang | *Nagoya University*

## Business

Thursday, August 4 , 2016

16:30-17:30

胡蝶の間

(KOCHO no MA)

Session Chair: *Chia-Hui Huang*

---

### ISBSS-6064

#### **An Empirical Study Regarding the Satisfaction Level of Taiwanese Youth Tourists to Japan**

Fumihiko Isada | *Kansai University*

Han-Ching Lin | *Chihlee University of Technology*

Yuriko Isada | *Kwansei Gakuin University*

### ISBSS-5413

#### **Big Data Classification with the Soft Margin Multi-Classifer Support Vector Machine**

Chia-Hui Huang | *National Taipei University of Business*

Han-Ying Kao | *National Dong Hwa University*

### ISBSS-5456

#### **The Influence of a Restaurant's Social Contributions and Green Practices on Customers' Decision to Buy in a Chinese Context.**

Choy Yip Hong, Sonny | *Technological and Higher Education Institute of Hong Kong*

### ISBSS-6083

#### **Framework for Studying the Perception of Alcohol Beverages Image and Alcohol Beverages Drinking Behavior of Thai Undergraduate Students**

Shawanluck Kunathikornkit | *Srinakharinwirot University*

Piyada Sombatwattana | *Srinakharinwirot University*



## Poster Session (1)

---

**Biomedical Engineering / Biotechnology Engineering /**

**Chemical Engineering / Life Science**

**Wednesday, August 3 , 2016**

**13:40-14:40**

守禮の間

(SHUREI no MA)

---

### **APICENS-1406**

**Analysis of Influenza A H3N2 HA Sequences Suggested the Vaccine Strains Circulated Several Years before They Were Administered in Taiwan**

Guang-Wu Chen | *Chang Gung University*

Shu-Ming Kuo | *Chang Gung University*

Shin-Ru Shih | *Chang Gung University*

### **APICENS-1421**

**Enhancement of Osteogenic on Zn Release with Zn Doped DLC Film Coating**

Junichi Katouno | *Tokyo Denki University*

Yasufumi Mabuchi | *Tokyo Denki University*

Yasuharu Ohgoe | *Tokyo Denki University*

Kenji Hirakuri | *Tokyo Denki University*

Kouki Fujioka | *Jikei University School of Medicine*

Yoshinobu Manome | *Jikei University School of Medicine*

Masanori Hiratsuka | *Nanotec Corporation*

Hitomi Tsuboi | *Nanotec Corporation*

Hideki Nakamori | *Nanotec Corporation*

Hideki Masuda | *NITI-ON Co, Ltd*

Hiroshi Honda | *NITI-ON Co, Ltd*

## **APICENS-1426**

### **Amino Group Modification on DLC Coating to Medical Application**

Kyoichi Terai | *Tokyo Denki University*

Yuta Murayama | *Tokyo Denki University*

Keisuke Sato | *Tokyo Denki University*

Kenji Hirakuri | *Tokyo Denki University*

Yasuharu Ohgoe | *Tokyo Denki University*

Jun Mizuno | *Waseda University*

Shuichi Shoji | *Waseda University*

## **IBCELC-28903**

### **Monitoring Microbial Growth of Biodiesel Blends: Under Different Sulfur Concentrations and Biocide Applications**

Jui-Hui Chen | *CPC Corporation, Taiwan*

Hsin-Yao Cheng | *CPC Corporation, Taiwan*

Chin-Chung Chen | *CPC Corporation, Taiwan*

Ai-Ling Kao | *CPC Corporation, Taiwan*

Chang-Ting Tsai | *CPC Corporation, Taiwan*

Zheng-Chia Tsai | *CPC Corporation, Taiwan*

## **IBCELC-28904**

### **A Study on Optimal Operating Conditions for the Second-Generation Bioethanol Production by Co-Fermentation of Glucose and Xylose from Rice Straw**

Chin-Chung Chen | *CPC Corporation, Taiwan*

Jui-Hui Chen | *CPC Corporation, Taiwan*

Hsin-Yao Cheng | *CPC Corporation, Taiwan*

Ai-Ling Kao | *CPC Corporation, Taiwan*

Chang-Ting Tsai | *CPC Corporation, Taiwan*

Zheng-Chia Tsai | *CPC Corporation, Taiwan*

Guo-Jhan Gao | *CPC Corporation, Taiwan*

### **IBCELC-28905**

#### **Conversion of Crude Glycerol, the Biodiesel Production By-Product, into Value-Add Chemical 2,3-Butanediol through Microbial Fermentation**

Hsin-Yao Cheng | *CPC Corporation, Taiwan*

Chin-Chung Chen | *CPC Corporation, Taiwan*

Jui-Hui Chen | *CPC Corporation, Taiwan*

Ai-Ling Kao | *CPC Corporation, Taiwan*

Chang-Ting Tsai | *CPC Corporation, Taiwan*

Zheng-Chia Tsai | *CPC Corporation, Taiwan*

### **IBCELC-28926**

#### **Process Simulation for Advanced Bioethanol Production from Nipa Sap through Acetic Acid Fermentation**

Dung Van Nguyen | *Kyoto University*

Harifara Rabemanolontsoa | *Kyoto University*

Eiji Minami | *Kyoto University*

Haruo Kawamoto | *Kyoto University*

Shiro Saka | *Kyoto University*

Pinthep Sethapokin

### **IBCELC-28947**

#### **Efficient Conversion of Lignocellulosic Hydrolyzates to Acetic Acid by Co-Immobilized *Clostridium thermocellum* and *Moorella thermoacetica* (*C. thermoacetum*)**

Harifara Rabemanolontsoa | *Kyoto University*

Piradee Jusakulvijit | *Kyoto University*

Shiro Saka | *Kyoto University*

### **IBCELC-28895**

#### **Recycle Photothermal Effect of Fe<sub>3</sub>O<sub>4</sub> and WO<sub>3</sub> Immobilized Montmorillonite Nanocomposites**

Mazrad Zihnil Adha Islamy | *Korea National University of Transportation*

Young Kwang Kim | *Korea National University of Transportation*

Choi Mina | *Korea National University of Transportation*

Sung Young Park | *Korea National University of Transportation*

**IBCELC-28906**

**Nanoporous Silica Aerogel Membranes for CO<sub>2</sub> Capture**

Yi-Feng Lin | *Chung Yuan Christian University*

**IBCELC-28941**

**Development of Colorimetric Sensor for Toxic Gas Detection Using Electrospun Thin Film**

Seung Kyun Yoon | *Sungkyunkwan University*

Sung Yeol Kim | *Sungkyunkwan University*

Jungho Ahn | *Sungkyunkwan University*

Dong June Chung | *Sungkyunkwan University*

**IBCELC-28951**

**Biomimetic Self-Assembly of Porphyrin-Conjugated Polyaspartamide for Molecular Ultrasound Imaging**

Jae Hyun Jeong | *Soongsil University*

Yoonna Cho | *Soongsil University*

Hee Jin Kim | *Soongsil University*

Sung Woo Cho | *Soongsil University*

Shin Sung Gyu | *Soongsil University*

**IBCELC-28889**

**Generation of the Enterotoxigenic Escherichia Coli Ghost Vaccine Candidate by GI24 and Its Protection Efficacy against Neonatal Piglet Colibacillosis**

Won Kyong Kim | *Chonbuk National University*

Ja Young Moon | *Chonbuk National University*

Jin Hur | *Chonbuk National University*

**IBCELC-28894**

**Interaction of Anesthetic Agents with Neuro-Active Indoleamine-Aldehyde Condensation Products**

Hironori Tsuchiya | *Asahi University*

Maki Mizogami | *University of Fukui*

**IBCELC-28900**

**Hernandezine, a Bisbenzylisoquinoline Alkaloid with Inhibitory Activity against Multidrug Resistance-Linked ATP-Binding Cassette Drug Transporter ABCB1**

Chung-Pu Wu | *Chang Gung University*

Sung-Han Hsiao | *Chang Gung University*

**IBCELC-28918**

**Predicting Oncogenes of Hepatocyte Using Genome-Scale Metabolic Model**

Meng-Chun Chen | *National Chung Cheng University*

Wen-Huan Liu | *National Chung Cheng University*

Feng-Sheng Wang | *National Chung Cheng University*

**IBCELC-28922**

**Heterologous Expression and Functional Characterization of the dTDP-2-Deoxyfucose**

**Biosynthetic Enzymes**

Hsien-Tai Chiu | *National Cheng Kung University*

Chien-Pao Weng | *National Cheng Kung University*

## Poster Session (2)

---

**Civil Engineering / Computer and Information Sciences /**

**Electrical and Electronic Engineering / Material Science and**

**Engineering / Business / Economics / Finance / Management**

**Wednesday, August 3, 2016**

**15:00-16:00**

守禮の間

(SHUREI no MA)

---

### **APICENS-1457**

**Estimation of Alien Subject Location in Concrete Slab Using Linear Travel Interpolation Method**

Hiromasa Kimata | *Daido University*

Tomohiro Nakano | *Tokai University*

### **APICENS-1464**

**Analysis of Debris Flow Run-out and Risk Computation According to Initial Mass Distributions and Defensive Structure Types**

Seung Myeong Oh | *Incheon National University*

Chang Geun Song | *Incheon National University*

Hyun Ju Jang | *Incheon National University*

### **APICENS-1460**

**Pseudo High Resolution Picture Generation Based on a Patch Library**

Yuji Saito | *Kokushikan University*

Shinya Nakajima | *Kokushikan University*

### **APICENS-1472**

**Novel Mobility Management based Context Awareness Networks**

Seungyong Shin | *Hannam University*

Byungjoo Park | *Hannam University*

### **APICENS-1393**

#### **Investigating Guided-Modes for Tilted Fiber Bragg Grating by Using Finite Element Method**

Yue-Jing He | *National Chin-Yi University of Technology*

Wei-Chih Hung | *National Chin-Yi University of Technology*

### **APICENS-1459**

#### **VLSI Implementation of 8051 MCU with Decoupling Capacitor for IC-EMC**

Pei-Jung Tsai | *National Taiwan Ocean University*

Mao-Hsu Yen | *National Taiwan Ocean University*

Yeong-Chang Maa | *National Taiwan Ocean University*

Chiu-Kuo Chen | *Ministry of Economic Affairs, R.O.C.*

Yen-Tang Chang | *Ministry of Economic Affairs, R.O.C.*

Ming-Yan Shyu | *National Taiwan Ocean University*

Shu-Ping Zheng | *National Taiwan Ocean University*

### **APICENS-1404**

#### **Cost-Effective $\alpha$ -Fe<sub>2</sub>O<sub>3</sub> Photocatalyst for Green Applications**

Chih-Ming Wang | *National Dong Hwa University*

### **APICENS-1424**

#### **Magnetic and fluorescence properties of Ammonium Silicon Fluoride/Iron Oxide Composite Microparticles**

Masaya Kudo | *Tokyo Denki University*

Keisuke Sato | *Tokyo Denki University*

Kenji Hirakuri | *Tokyo Denki University*

### **APICENS-1425**

#### **Multi-Color Fluorescence of (NH<sub>4</sub>)<sub>2</sub>SiF<sub>6</sub>/POx Composite Microparticles**

Masayuki Suzuki | *Tokyo Denki University*

Keisuke Sato | *Tokyo Denki University*

Kenji Hirakuri | *Tokyo Denki University*

**APICENS-1427**

**The Effect of Ar Addition on the Structural and Tribological Properties of Nanodiamond Films Grown by MPCVD**

Jong Cheon Park | *Pusan National University*

Byoung Su Choi | *Pusan National University*

Jin Kon Kim | *Pusan National University*

Sungu Hwang | *Pusan National University*

Hyun Cho | *Pusan National University*

**ISBSS-5421**

**A Stochastic Programming Model to Solve the Capacity Expansion Problem Considering Auxiliary Tools: A Semiconductor Foundry Case**

Yin-Yann Chen | *National Formosa University*

**ISBSS-6074**

**Passenger Demand Model for Airport-Pairs Routes within Dual-Airport System**

Chih-Wen Yang | *National Taichung University of Science and Technology*

**ISBSS-5284**

**The Effect of Information Disclosure on Adoption of Coercive Regulation: U. S. Renewable Energy Policies on Electric Utilities**

Hyunhoe Bae | *Yonsei University*

Sanguk Yu | *Yonsei University*

**ISBSS-5467**

**The Study about Price Premiums of Sale-Leaseback in Real Estate Markets**

Chin-Ming Chen | *National Kaohsiung First University of Science and Technology*

**ISBSS-6046**

**A Structural Analysis of Housing Value**

Ming-Chi Chen | *National Chengchi University*

Chih-Hsing Hung | *National Kaohsiung First University of Science and Technology*

**ISBSS-6075**

**The Asymmetry Trading Behavior of Mutual Fund Investors in Taiwan**

Nan-Yu Wang | *Ta Hwa University of Science and Technology*

Sen-Sung Chen | *Feng-Chia University*

Chih-Jen Huang | *Providence University*

Shih-Heng Hsiao | *Feng-Chia University*



**ISBSS-6077**

**The Trading Behavior of Stock Investors under Different Trading Mechanisms –  
Evidences from Vietnam HoChiMinh Stock Exchanges and Hanoi Stock Exchanges**

Ming-Chun Wang | *National Kaohsiung First University of Science and Technology*

**ISBSS-5470**

**Brand Evangelism Effects on Facebook Fan Pages: An Integrated Perspective of  
Self-Congruity and Social Identify Theory**

Li-Chun Hsu | *National Taitung University*

**ISBSS-6047**

**Contribution of Japanese Management Accounting on the Research: A Bibliographic  
Study on English Journals**

Keita Iwasawa | *Keio University*

Eisuke Yoshida | *Keio University*

## Poster Session (3)

---

Communication / Education / Sociology / Psychology / Politics

Wednesday, August 3 , 2016

16:20-17:20

守禮の間

(SHUREI no MA)

---

### ISBSS-6091

**A Study on the Influences of the Third-Person Effect According to the Type of Emotional Response to Advertising of Digital Products**

Younho Kim | *Pukyong National University*

Changhoon Park | *Gabs&D Company*

Chunggun Jang | *Pukyong National University*

### ISBSS-6958

**Analyzing the Determinant of Risk Perception about MERCI**

Seoyong Kim | *Ajou University*

Sunhee Kim | *Seowon University*

### ISBSS-6967

**Explore the Impact of Satirical User-Generated Content in 2016 Taiwanese Presidential Election**

Chi Ying Chen | *Asia University*

Man Ting Pan | *Asia University*

### ISBSS-6969

**LINE Communication in the 2016 Taiwanese Presidential Election**

Chi Ying Chen | *Asia University*

Tang Wei Lin | *Asia University*

### ISBSS-6971

**Strategies to Structure the Facebook Messages during the 2016 Taiwanese Presidential Election**

Chi Ying Chen | *Asia University*

Hsin Yen Lin | *Asia University*

**ISLLE-1351**

**Development of Physical Computing Curriculum Using Android Devices and S4A**

Tae-Woo Kim | *Seoul National University of Education*

Seok-Ju Chun | *Seoul National University of Education*

**ISLLE-1350**

**Development Worksheets in Scratch Programming Education for Elementary School Students**

Minho Jang | *Seoul National University of Education*

**ISLLE-1326**

**A Study on the Instructional Design of Software Education Based on Backward Design Model**

Youngho Lee | *Seoul National University of Education*

Dukhoi Koo | *Seoul National University of Education*

**ISLLE-1359**

**Visual Awareness Performance in Reading Texts on Paper versus Tablet in Indonesian Elementary School Students**

Siti Dian Mardiyani | *University of Tsukuba*

Toshiharu Enomae | *University of Tsukuba*

Naohiro Higuchi | *University of Tsukuba*

**ISLLE-1356**

**An Evaluative Study on the Feasibility of “Primer Design for PCR” as a Lesson in High School Biology Curriculum**

Yang-Tsung Chung | *National Chung Hsing University*

Su-Ling Hwang | *National Chung Hsing University*

**ISLLE-1328**

**Teaching Science Text to Elementary School EFL Learners**

Yueh-Nu Hung | *National Taichung University of Education*

Pin-Hsuan Lin | *Hsin-Hsiang Elementary School*

Shih-Chieh Liao | *China Medical University*

**ISBSS-6057**

**Interpretation of Interior Design Education Refer to the Process of Hotel Design**

Tsann-Chung Wu | *Chung Yuan Christian University*



**ISBSS-6116**

**Determination of Reading Level by Comparing Results of an Online Placement Test, Standardized Tests and Student Deduction**

Kurt William Ackermann | *Hokusei Gakuen University Junior College*

**ISBSS-6099**

**Study of the Postures which Cause Physical Strain to the Elderly Care Workers**

Hiroaki Fujii | *Fukuyama Heisei University*

Mai Fukushina | *Special Elderly Nursing Home "Honobono-en"*

Yuki Ujihara | *Fukuyama Heisei University*

**ISBSS-6982**

**Lessons Learned from the Philosophy of Sufficiency Economic Used for Environmental Management in Bangnamphueng Community, Phrapadaeng District, Samutprakan Province, Thailand**

Kallyanee Kullachai | *Srinakarinwirot University*

**ISBSS-6960**

**Components of Comfort in Residential Space**

Shih-Yung Liu | *Chung Yuan Christian University*

Yi-Ching Liu | *Tungnan University*

**ISBSS-6073**

**Regarding the Efficacy of "Providing Information Relating to Nursing" through the Use of Free Informative Magazines**

Taizo Ito | *Fukuyama Heisei University*

Yuki Ujihara | *Fukuyama Heisei University*

**ISBSS-6117**

**Using Semantic Differential to Study Images Expect Vocabulary on Design and Lifestyle Ethnic Groups**

Peng Jyun Liu | *National Chiao Tung University & Asia university*

Ming-Chuen Chuang | *National Chiao Tung University*









