

Conference Program

February 18-20, 2016
Singapore

TICEAS

The International Conference on Engineering and Applied Sciences

GCBENS

Global Conference on Biological Engineering and Natural Science

APSSSM

Asia-Pacific Symposium on Social Science and Management

ICEASS

International Conference on Education and Social Sciences

TICEAS

The International Conference on Engineering and Applied Sciences

ISBN 978-986-5654-07-8

GCBENS

Global Conference on Biological Engineering and Natural Science

ISBN 978-986-5654-37-5

APSSSM

Asia-Pacific Symposium on Social Science and Management

ISBN 978-986-5654-36-8

ICEASS

International Conference on Education and Social Sciences

ISBN 978-986-89844-5-5

General Information for Participants	5
International Committees.....	7
International Committee of TICEAS.....	7
International Committee of GCBENS	8
International Committee of APSSSM	9
International Committee of ICEASS	11
Special Thanks to Session Chairs.....	13
Conference Venue Information	14
Conference Schedule.....	15
Natural Sciences Keynote Speech.....	18
Social Sciences Keynote Speech	19
Oral Sessions.....	20
Education (1)	20
Civil Engineering (1)	21
Education (2)	22
Environmental Engineering	24
Politics/ Society (1).....	26
Education (3)	27
Biomedical Engineering/ Natural Sciences	29
Management (1)	31
Economics (1)/Finance	32
Chemical Engineering/ Fundamental and Applied Sciences/ Material Science and Engineering.....	33
Culture/Psychology/Society (2)	35
Management (2)	37
Computing Science & IT Engineering.....	38
Management (3) /Communication	39
Electrical & Electronic Engineering.....	41
Education (4)	43
Mechanical Engineering	44
Economics (2).....	45
Civil Engineering (2)	47
Education (5)	49
Education (6)	51
Poster Session (1)	52

Biomedical Engineering/ Chemical Engineering/ Computing Science & IT Engineering (1)	52
Poster Session (2)	56
Material Science and Engineering/Mechanical Engineering	56
Poster Session (3)	59
Education(1)/Law/Management/Psychology	59
Poster Session (4)	61
Civil Engineering/ Environmental Engineering/ Natural Sciences	61
Poster Session (5)	64
Computing Science & IT Engineering (2)/Electrical & Electronic Engineering/ Fundamental and Applied Sciences	64
Poster Session (6)	67
Education(2)/ Economics	67

General Information for Participants

■ **Registration**

The registration desk will be situated on the **5th Floor** at the **Peninsula Tower, Peninsula Excelsior Hotel** during the following time:

08:00-17:30 Friday, February 19, 2016

08:30-17:00 Saturday, February 20, 2016

■ **Organizer**



Higher Education Forum (HEF)

Tel: + 886 2 2740 1498 | www.prohef.org



■ **A Polite Request to All Participants**

Participants are requested to arrive in a timely fashion for all addresses. Presenters are reminded that the time slots should be divided fairly and equally by the number of presentations, and that they should not overrun. The session chair is asked to assume this timekeeping role and to summarize key issues in each topic.



Sandals or Slippers



Tank Top



Shorts

■ **Certificate**

Certificate of Presentation or Certificate of Attendance

A certificate of attendance includes participant's name and affiliation, certifying the participation in the conference. A certificate of presentation indicates a presenter's name, affiliation and the paper title that is presented in the scheduled session.

Certificate Distribution

Oral presenters will receive a certificate of presentation from the session chair after their presentations or at the end of the session. Poster presenters will receive a certificate of presentation from the conference staff at the end of their poster session.

The certificate of presentation will not be issued, either at or after the conference, to authors whose papers are registered but not presented. Instead, the certificate of attendance will be provided after the conference.

■ Preparation for Oral Presentations

All presentation rooms are equipped with a screen, an LCD projector, and a laptop computer installed with Microsoft PowerPoint. You will be able to insert your USB flash drive into the computer and double check your file in PowerPoint. We recommend you to bring two copies of the file in case that one fails. You may also connect your own laptop to the provided projector; however please ensure you have the requisite connector.

Preparation for Poster Presentation

Materials Provided by the Conference Organizer:

1. X-frame display & base fabric canvases (60cm×160cm)
2. Adhesive tapes or binder clips

Materials Prepared by the Presenters:

3. Home-made poster(s)
4. Material: not limited, can be posted on the canvases
5. Recommended poster size: 60cm*160cm



<p>A 60cm*160cm poster illustrates the research findings.</p>	<ol style="list-style-type: none"> 1. Wider than 60cm (left) 2. Copy of PowerPoint slides in A4 papers (right)

International Committees

International Committee of TICEAS

Prof. C H OH Physics Department, Faculty of Science, National University of Singapore, Singapore

Prof. Lim Koon Ong Pk Deputy Vice-Chancellor, School of Physics, Universiti Sains Malaysia, Malaysia

Prof. Parin Chaivisuthangkura Deputy Dean for Academic Affairs, Department of Biology, Srinakharinwirot University, Thailand

Prof. Zulkifli Hj. Shamsuddin Dept. of Land Management, Universiti Putra Malaysia, Malaysia

Prof. Avinash C. Sharma School of Basic & Applied Sciences, GGS Indraprastha University, India

Prof. E. Shaji Department of Geology, University of Kerala, India

Prof. A. M. Chandra Department of Physiology, University of Calcutta, India

Prof. Chien-Cheng Chang Institute of Applied Mechanics, National Taiwan University, Taiwan

Dr. Stephen Redmond Graduate School of Biomedical Engineering, The University of New South Wales, Australia

Prof. J. Gao Department of Physics, The University of Hong Kong, Hong Kong

Prof. P.K.Barhai Dean, Faculty & Sponsored Research, Department of Applied Physics, Birla Institute of Technology, India

Prof. Singh, Gauri Shankar Department of Physics, Indian Institute of Technology Roorkee, India

Asst. Prof. Mohd. Nasir Mohd. Desa Department of Biomedical Sciences, Universiti Putra Malaysia, Malaysia

Prof. Aliakbar Roodbari Environmental Health Engineering , Shahroud University of Medical Sciences, Iran

Prof. Olivia J Fernando Centre of Advanced Study in Marine Biology, Annamalai University, India

Prof. K. Padmakumar Centre for Marine Biodiversity, Kerala University Campus, India

Prof. John Hearne Mathematical and Geospatial Sciences, Royal Melbourne Institute of Technology, Australia

Prof. Hamed M. El-Shora Botany Department, Mansoura University, Egypt

Prof. Huabei Jiang Biomedical Engineering, The University of Florida, USA

International Committee of GCBENS

Professor C H OH Physics Department, Faculty of Science, National University of Singapore

Prof. Lim Koon Ong Pk Deputy Vice-Chancellor, School of Physics, Universiti Sains Malaysia, Malaysia

Prof. Parin Chaivisuthangkura Deputy Dean for Academic Affairs, Department of Biology, Srinakharinwirot University, Thailand

Prof. Zulkifli Hj. Shamsuddin Dept of Land Management, Universiti Putra Malaysia, Malaysia

Prof. Avinash C. Sharma School of Basic & Applied Sciences, GGS Indraprastha University, India

Prof. A. M. Chandra Department of Physiology, University of Calcutta, INDIA

Prof. Chien-Cheng Chang Institute of Applied Mechanics, National Taiwan University, Taiwan

Dr. Stephen Redmond Graduate School of Biomedical Engineering, The University of New South Wales, Australia

Prof. J. Gao Department of Physics, The University of Hong Kong, Hong Kong

Prof. P.K.Barhai Dean, Faculty & Sponsored Research, Department of Applied Physics, Birla Institute of Technology, India

Prof. Singh, Gauri Shankar Department of Physics, Indian Institute of Technology Roorkee, India

Asst. Prof. Mohd. Nasir Mohd. Desa Department of Biomedical Sciences, Universiti Putra Malaysia, Malaysia

Prof. Aliakbar Roodbari Environmental Health Engineering , Shahroud University of Medical Sciences, Iran

Prof. Olivia J Fernando Centre of Advanced Study in Marine Biology, Annamalai University, India

Prof. K. Padmakumar Centre for Marine Biodiversity, Kerala University Campus

Prof. John Hearne Mathematical and Geospatial Sciences, Royal Melbourne Institute of Technology, Australia

Prof. Hamed M. El-Shora Botany Department, Mansoura University, Egypt

Prof. Huabei Jiang Biomedical Engineering, The University of Florida, USA

International Committee of APSSSM

Abbas Gholtash Faculty of Educational Sciences and Psychology, Marvdasht Branch, Islamic Azad University, Iran

Adrian North Psychology and Speech Pathology, Curtin University, UK

Armin Mahmoudi Department of Education, Academic Member University, Iran

Asrul Akmal Shafie Discipline of Social & Administrative Pharmacy, University of Malaya, Malaya

Awam Amkpa Social and Cultural Analysis, New York University, USA

Bishnu Mohan Dash Department of Social Work, University of Delhi, India

Cai Su Department of Education, Beijing Normal University, China

Channaveer Rachayya Mathapati Davangere University, Department of Social Work, India

Debkumar Chakrabarti Department of Design, Indian Institute of Technology Guwahati, India

Geoffrey I. Nwaka Department of History, Abia State University, Nigeria

I Wayan Suyadnya Department of Sociology, Brawijaya University, Indonesia / Institute for Social and Cultural Anthropology and The Ethnographic Collection, Georg-August University of Goettingen, Germany

Laura B. Liu, Ed.D. Beijing Normal University's Center for Teacher Education Development, China

Leela Pradhan Central Department of Education, Tribhuvan University Kathmandu, Nepal

Lee Byung Hyuk Department of Sociology, University of Seoul, Korea

Li-Ling Yang School of Education, Roger Williams University, USA

Lee, Yang Department of Psychology, Gyeongsang National University, South Korea

Haskins Laboratories, Yale University, US

Mahabbat Pernebaevna Ospanbaeva Faculty of Education, Taraz State Pedagogical Institute, Kazakhstan

Khalachuchi Flores Department of Social Work, Southwestern University, Philippines

Md Abdul Jalil Department of Social Work, Shahjalal University of Science & Technology, Bangladesh

Mohamed Azmi Ahmad Hassali Discipline of Social & Administrative Pharmacy, School of Pharmaceutical Sciences, Universiti Sains Malaysia, Malaysia

Napaporn Srichanyachon Language Institute, Bangkok University

Özlem AVCI Department of Sociology, Uşak University, Turkey

Rajeshwari Nagaraj Kenchappanavar Department of Psychology, Karnatak Arts College, India

Reyhan Bilgiç Department of Psychology, Middle East Technical University, Turkey

Rizwana Yousaf Lecturer Sociology, University of Gujrat, Pakistan

Robert Evola Department of Psychology, Université de Yaoundé, Cameroon

Sakina Riaz Department of Social Work, University of Karachi, Pakistan

Subhan El Hafiz Department of Psychology, Muhammadiyah University, Indonesia

Tirelo Modie-Moroka Department of Social Work, University of Botswana, Botswana

Ying Xing School of Sociology, China University of Political Science and Law, China

Young-Ok Kim Department of Early Childhood Education, Chonnam National University,
Korea

International Committee of ICEASS

A.J.W. Taylor, Victoria University of Wellington, New Zealand
Allen John, The Open University, United Kingdom
Ann Salmonson, University of Alberta, Canada
Christian C.P. Wolff, University of Luxembourg, Luxembourg
Christina Hong-Joe, Queensland University of Technology, Australia
Craig Mark, Kwwansei Gakuin University, Japan
Debashish Chakrabarti, Ministry of Higher Education College of Applied Sciences, Oman
Debra Friedman, Arizona State University, United States
Durrishah Idrus, University Technology Malaysia, Malaysia
Edward Erwin, University of Miami, United States
Elesa Argent, London Metropolitan University, United Kingdom
Eric Gutierrez, NewGlobalEd, United States
Gabriele Ciampini, University of Florence, Italy
Gad Barzilai, University of Washington, United States
Gobi Krishna Sinniah, University Technology Malaysia, Malaysia
Ha In Bong, Kyungpook National University, Korea
Hassan Abbas, Columbia University, United States
Horace Campbell, Syracuse University, United States
Hui Tak-Kee, National University of Singapore, Singapore
Jaco Greeff Brink, Stellenbosch University, South Africa
Jennifer Chan Kim Lian, University Malaysia Sabah, Malaysia
Jeong Kiho, Kyungpook National University, Korea
Jiri Preis, University of West Bohemia, Czech Republic
Jolanta Babiuch-luxmoore, Oxford Brookes University, United Kingdom
Keunyeob Oh, Chungnam National University, Korea
Keya Sengupta, Indian Institute of Management, India
Kwok Chi-for, Angus, Hang Seng Management College, Hong Kong
Marc Holzer, The State University of New Jersey, United States
Maria A. Batishcheva, Lomonosov Moscow State University, Russia
Md. Ghulam Murtaza, Khulna University, Bangladesh
Mythili K., Seshadripuram Evening Degree College, Bangalore
Ng Sin Huei, INTI International University, Malaysia
Noorhayati Mansor, University Malaysia Sabah, Malaysia
Otávio Bueno, University of Miami, United States
Sajid Anwar, University of the Sunshine Coast, Australia
Sam S. Gill, San Francisco State University, United States
Solomon Akrofi, University of Southampton, United Kingdom

Somsouk Sananikone, Khon Kaen University, Thailand
Takuma Nishimura, University of Tsukuba, Japan
Theeraphong Bualar, Silpakorn University, Thailand
Tom Baum, University of Strathclyde, United Kingdom
Vernon Valentine Palmer, Tulane University Law School, United States
Wan Khairuzzaman Wan Ismail, University Technology Malaysia, Malaysia
Zhao Qiuyan, Beijing Normal University, China
Kamonsak Suradom, King Mongkut's University of Technology North Bangkok, Thailand
Daniele Massaccesi, University College Cork, Ireland

Special Thanks to Session Chairs

Taik Kim	New Mexico Highlands University
Jian-Hong Wu	National Cheng Kung University
Yi-Gean Chen	National University of Tainan
Bernard Twaróg	Cracow University of Technology
Sofa Marwah	Jenderal Soedirman University
Ya-Chin Tsai	National Chiayi University
Man Hee Rhee	Kyungpook National University
Rikiya Tsuchihashi	Nagasaki University
Yang-Kyu Shin	Daegu Haany University
Ur Ryong Cho	Korea University of Technology and Education
Shu Hui Lin	National Taiwan Normal University
Irene Hau Siu Chow	Hang Seng Management College
Isara Nakavisute	Sripratum University
Indrianawati Usman	Airlangga University
Seokho Yoon	Sungkyunkwan University
Simona Vasilache	University of Tsukuba
Ryspek Usubamatov	University Malaysia Perlis
Bo Yang	University of Surrey & Xi'an
Tomohiro Nakano	Tokai University
Remalyn Q. Casem	Don Mariano Marcos Memorial State University
Henry Ma	The Hong Kong Polytechnic University

Conference Venue Information

The 5th Floor, Peninsula Tower, Peninsula Excelsior Hotel

5 Coleman Street, Singapore 179805

Tel: (65) 6337 2200

Direction by SMRT

1. Take North-South Line (NSL) or East-West Line (EWL) and get off at City Hall Station
2. Take Exit B and walk five minutes to the venue



Floor Map (5th Floor, Peninsula Tower)

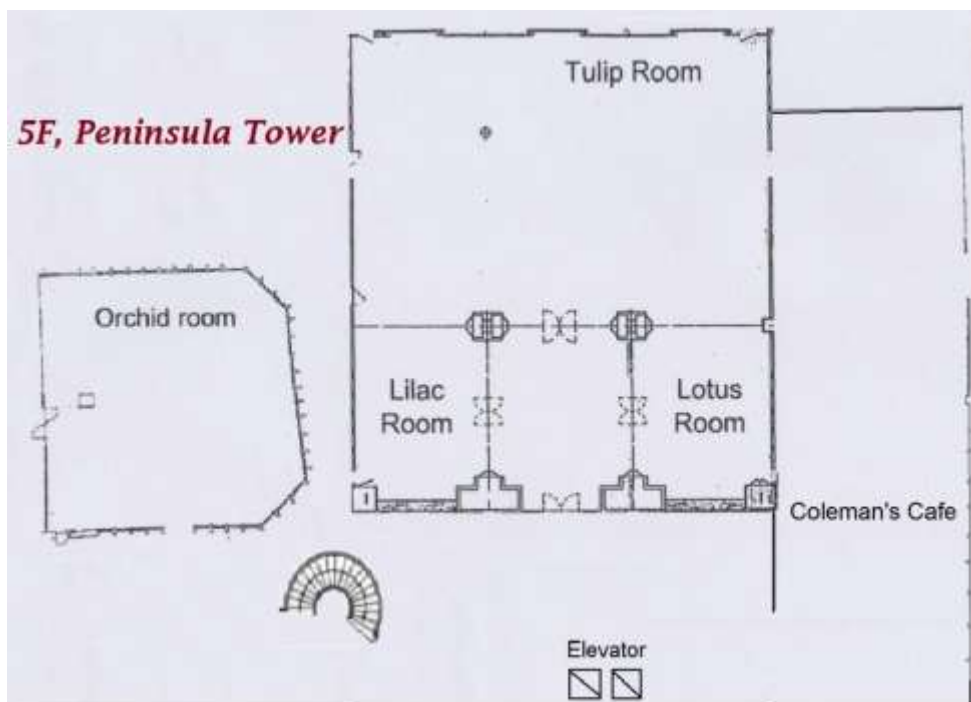

Conference Schedule

Thursday, February 18, 2016

**HEF Internal Training & Executive Meeting
(HEF Staff Only)**

Friday, February 19, 2016

Oral Session (5th Floor)

Time	Schedule	Venue
08:00-17:30	Registration	5 th Floor
08:45-10:15	Education (1)	Lilac
	Civil Engineering (1)	Lotus
10:15-10:30	Tea Break	Pre Function Area
10:30-12:00	Social Science Keynote Speech	Lilac
	Natural Science Keynote Speech	Lotus
12:00-13:00	Lunch	Coleman's Café
13:00-14:30	Education (2)	Lilac
	Environmental Engineering	Lotus
	Politics / Society(1)	Orchid
14:30-14:45	Tea Break	Pre Function Area
14:45-16:15	Education (3)	Lilac
	Biomedical Engineering/ Natural Sciences	Lotus
	Management (1)	Orchid
16:15-16:30	Tea Break	Pre Function Area
16:30-18:00	Economics(1)/ Finance	Lilac
	Chemical Engineering/ Fundamental and Applied Sciences/ Material Science and Engineering	Lotus
	Culture/ Psychology/ Society(2)	Orchid

Friday, February 19, 2016
Poster Session (Pre-Function Area, 5th floor)

Time	Schedule
09:00-10:00	Poster Session (1)
	Biomedical Engineering/ Chemical Engineering/ Computing Science & IT Engineering (1)
14:00-15:00	Poster Session (2)
	Material Science and Engineering/ Mechanical Engineering
15:30-16:30	Poster Session (3)
	Education (1)/ Law/ Management/ Psychology

Saturday, February 20, 2016 Oral Session (5th Floor)		
Time	Information	Venue
08:30-17:00	Registration	5 th Floor
08:45-10:15	Management (2)	Lilac
	Computing Science & IT Engineering	Lotus
10:15-10:30	Tea Break	Pre Function Area
10:30-12:00	Management (3)/ Communication	Lilac
	Electrical & Electronic Engineering	Lotus
12:00-13:00	Lunch	Coleman's Café
13:00-14:30	Education (4)	Lilac
	Mechanical Engineering	Lotus
14:30-14:45	Tea Break	Pre Function Area
14:45-16:15	Economics (2)	Lilac
	Civil Engineering (2)	Lotus
16:15-16:30	Tea Break	Pre Function Area
16:30-18:00	Education (5)	Lilac
	Education (6)	Lotus

Saturday, February 20, 2016 Poster Session(Pre-Function Area, 5th floor)	
Time	Schedule
09:00-10:00	Poster Session (4)
	Civil Engineering/ Environmental Engineering/ Natural Sciences
14:00-15:00	Poster Session (5)
	Computing Science & IT Engineering(2) / Electrical & Electronic Engineering/ Fundamental and Applied Sciences
15:30-16:30	Poster Session (6)
	Education (2)/Economics

Natural Sciences Keynote Speech

Lotus Room

10:30-12:00 Friday February 19, 2016

Topic: Development of Cell-Based Assays for Measuring Hypoxia-Inducible Factor Activities

Norazizah Shafee
Deputy Dean
Faculty of Biotechnology and Biomolecular Sciences
Universiti Putra Malaysia
Malaysia



Abstract:

Cell-based assay systems have become increasingly popular in modern drug discovery. Currently, these assays are used for lead identification, dose optimization as well as target validation. The use of miniaturized high-throughput techniques makes these cell-based assays more efficient and cost-effective for drug screening. These assays are preferred over other in-vitro methods since they give direct cellular functional responses to the drug target of interest. This allows for clearer understanding of physiological and pharmacological responses to the target. Hypoxia inducible factor (HIF) has been shown to be involved in various cellular regulations from stem cell differentiation, proliferation, cellular apoptosis to cancer development. Discovery of its central roles in normal cell functions as well as disease development and progression has raised the need for a more robust cell-based assay system to measure HIF activities. Unfortunately, the currently available systems offer limited options. They are very costly with limited sensitivity. However, due to the lack of alternative options, researchers are confined with these assays and their limitations. In the present study, we developed a highly sensitive and robust cell-based assay system that can be used to evaluate HIF activities in drug discovery. A selected hypoxia response element of a HIF target gene was utilized to drive the expression of a firefly luciferase reporter gene. The correlation of luciferase expression and HIF activities was confirmed by examining their specificity, linearity, precision, accuracy, robustness and sensitivity in various experimental conditions. Findings from this study will contribute towards accelerating the screening process of HIF-related drug candidates leading to faster identification of new therapeutic drugs.

Social Sciences Keynote Speech

Lilac Room

10:30-12:00 Friday February 19, 2016

Topic: E-Learning in Tertiary Institution in Singapore



Dr Tan Khay Boon
Singapore Institute of Management Global Education

The speech outline:

E-learning has been practiced in Singapore for a long time but the results are mixed. The speech provides some background information of e-learning in tertiary institution in Singapore and focuses on the development and deployment process e-courses. The speech also discuss the roles of the e-course developer, the learning development specialist and the e-course instructor. It highlights the experiences accumulated from the e-courses taught in tertiary institutions and specifies some do and don't in the e-course development and deployment process.

Introduction of the speaker:

Dr Tan Khay Boon is a working at Singapore Institute of Management Global Education. He is also an assistant Editor of Singapore Economic Review. He holds a PhD from Nanyang Technological University, Master of Social Science in Economics and Bachelor of Social Science (Honours) from National University of Singapore. He began his teaching career in 1995 as a lecturer at the Temasek Business School Temasek Polytechnic, before moving on to lecture in Economics in the School of Humanities of Social Sciences, Nanyang Technological University and the School of Business, SIM University. During his teaching career, Dr Tan has taught various economic modules including international economics, macroeconomics, managerial economics, econometrics, time series analysis and forecasting. He has also published his research in reputed journals and the daily newspapers.

Education (1)

Friday, February 19, 2016 08:45-10:15 Lilac Room

Session Chair: *Prof. Taik Kim*

ICEASS-1708

Ultra-Orthodox Women in Higher Education: Tradition, Modernity and the Regulating Role of Concerns

Osnat Rubin | *University of Haifa*

ICEASS-1720

The Antecedent of Children Education Achievement Farmers Pond in Sidoarjo, East Java

Mashudi Mashudi | *Muhammadiyah University of Sidoarjo*

ICEASS-1797

A Review of Culturally Responsive Practices and Students' Mathematical Identity and Discourse

Duanghathai Katwibun | *Chiang Mai University*

ICEASS-1799

Mid-Egypt Professors and Students' Perceptions of the University as a Knowledge Society

Mohamed Hammad Hendy | *Beni-Suef University*

APSSSM-1377

Dialects and Community Based Tourism in Thailand

Saneh Dechawongse | *Dhurakij Pundit University*

ICEASS-1725

Improving Student Learning in Mathematics by Using New and Existing STEM Assets

Taik Kim | *New Mexico Highlands University*

Civil Engineering (1)

Friday, February 19, 2016 08:45-10:15 Lotus Room

Session Chair: *Prof. Jian-Hong Wu*

TICEAS-1283

Study on Quality Control Using the Electrical Resistivity of the Cement Milk in Embedded Pile

Masato Matsuura | *Ritsumeikan University*

Yasuhide Mochida | *Ritsumeikan University*

TICEAS-1299

Development of CFRTP Rod Using the Thermoplastic Resin - The Effects of Mechanization of the Production Line -

Hiroyuki Kitayama | *Ritsumeikan University*

Honami Noda | *Komatsuseiren Corporation*

Yasuhide Mochida | *Ritsumeikan University*

TICEAS-1303

Finite Element Analysis of Concrete-Filled Tube (CFT) Subjected to Shear

Eun-Bi Jung | *Seoul National University of Science & Technology*

Jung-Han Yoo | *Seoul National University of Science & Technology*

Seo Haeng Lee | *Seoul National University of Science & Technology*

Dawn E Lehman | *University of Washington*

Charles W Roeder | *University of Washington*

TICEAS-1325

Simulating the Impact Area of the Residual Slope at Chiu-Fen-Erh-Shan, Taiwan Using 3DEC

Jian-Hong Wu | *National Cheng Kung University*

Wei-Kang Lin | *National Cheng Kung University*

Hsuan-Teh Hu | *National Cheng Kung University*

Education (2)

Friday, February 19, 2016 13:00-14:30 Lilac Room

Session Chair: *Prof. Yi-Gean Chen*

ICEASS-1761

Investigating the Access to Mathematics and Conceptual Understanding of 10th Grade Students in a Problem-Based Learning (PBL) Classroom

Patiphat Tittha | *Chiang Mai University*

Duanghathai Katwibun | *Chiang Mai University*

ICEASS-1771

10th Grade Students' Metacognition in Mathematics Problem-Based Learning (PBL) Classroom

Jaturong Lertchuwongsa | *Chiang Mai University*

Duanghathai Katwibun | *Chiang Mai University*

ICEASS-1770

11th Grade Students' Engagement in Mathematics Problem-Based Learning (PBL) Classroom

Tienchai Chamason | *Chiang Mai University*

Duanghathai Katwibun | *Chiang Mai University*

ICEASS-1781

7th Grade Students' Mathematical Identity in a Problem-Based Learning (PBL) Classroom: A Pilot Study

Boontarika Bupprachatkul | *Chiang Mai University*

Duanghathai Katwibun | *Chiang Mai University*

ICEASS-1792

11th Grade Students' Mathematics Self-Efficacy in a Problem-Based Learning (PBL) Classroom

Supawan Jaikhamsook | *Chiang Mai University*

Duanghathai Katwibun | *Chiang Mai University*

ICEASS-1808

Private Preschools' Operational Risk and Risk Management Solutions

Yi-Gean Chen | *National University of Tainan*

Jao-Nan Cheng | *National Taitung University*

Environmental Engineering

Friday, February 19, 2016 13:00-14:30 Lotus Room

Session Chair: *Prof. Bernard Twaróg*

TICEAS-1287

Oxidative Decolorization of Orange-II Dye with Chloramine-T: Delineation of Reaction Mechanism and Kinetic Modeling

Nirmala Vaz | *Jyoti Nivas College*

A. S. Manjunatha | *Bangalore University*

Puttaswamy | *Bangalore University*

TICEAS-1301

Removal of Heavy Metals (Fe, Co and Ni) from Spent Electro-Decontamination Solution Using Organic Acids and Regeneration of Phosphoric Acid

Marufa Naznin | *Kyungpook National University*

Won Sik Shin | *Kyungpook National University*

TICEAS-1317

Effect of Pressure, Temperature and Liquid to Solid Ratio on Aqueous Carbonation

Husna Inna | *Kyungpook National University*

Hye Ok Park | *Kyungpook National University*

Won Sik Shin | *Kyungpook National University*

TICEAS-1344

Study of Persulfate Slow Release Candle Depletion during PAHs and Benzene Oxidation

Ardie Septian Sarmanik | *Kyungpook National University*

Won Sik Shin | *Kyungpook National University*

TICEAS-1331

An Assessment of Risks Posed by Control Rule Parameters Implemented in a Flood Control Reservoir, Carried out with the Application of Elements of Ruin Theory and of Bivariate Distribution of a Random Variable Based on the Copula Function

Bernard Twaróg | *Cracow University of Technology*

APSSSM-1461

Impacts of Flood on Environment

Edy Lisdiyono Lisdiyono | *University of 17 Agustus 1945 Semarang*

Politics/ Society (1)

Friday, February 19, 2016 13:00-14:30 Orchid Room

Session Chair: *Prof. Sofa Marwah*

APSSSM-1393

The Three Links; Its implication to Korean Peninsula

Minki Jung | *National Chung Hsing University*

ICEASS-1751

Disaster Management in the South China Sea: A Chance for Peace and Cooperation

Gregory Coutaz | *National Chengchi University*

ICEASS-1765

The Effect of Violence Experience by Users and Provision Organization Support on Caregivers Turnover Intention

Min joo Kim | *Keimyung University*

Eun gu Ji | *Keimyung University*

Young kwang Lee | *Keimyung University*

ICEASS-1838

Traditional Village in Village Governmental Policy Order in Indonesia

Sofa Marwah | *Jenderal Soedirman University*

Riris Ardhanariswari | *Jenderal Soedirman University*

ICEASS-1782

History, Education, and Reconciliation in East Asia

Xiaohua Ma | *Osaka University of Education*

Education (3)

Friday, February 19, 2016 14:45-16:15 Lilac Room

Session Chair: *Prof. Ya-Chin Tsai*

APSSSM-1376

The Use of Strategies in Foreign Language Learning of Undergraduate Students

Somporn Gomaratut | *Dhurakij Pundit University*

APSSSM-1384

Does Input Enhancement Help with L2 Learning?

Ya-Chin Tsai | *National Chiayi University*

ICEASS-1737

Chinese TEFL Teachers' Understanding of Research and Its Significance: A Comparative Study of Two Higher Education Institutions in China

Li Bai | *Queensland University of Technology*

Peter Hudson | *Queensland University of Technology*

ICEASS-1787

The Roles of Vocabulary Knowledge and Grammar Knowledge in L2 Reading Comprehension depending on Topic Familiarity

Hyun Jeong Lee | *Pusan National University*

Jihyun Jeon | *Pusan National University*

ICEASS-1869

Depictives and Non-Overt Antecedents: Adjunct Control

Hyojung Lee | *Pusan National University*

ICEASS-1783

Overpassivization of Unaccusatives in ESL: Effects from Tense and the Morphological Form -ed.

Joo Hyun Kim | *Pusan National University*

APSSSM-1414

A Study of the Style of Digital Sketch Pens Used by Children

Chih-Kai Sung | *Tatung University*

Tung-Hsun Chen | *Tatung University*

Pei-Jung Cheng | *Tatung University*

Biomedical Engineering/ Natural Sciences

Friday, February 19, 2016 14:45-16:15 Lotus Room

Session Chair: *Prof. Man Hee Rhee*

GCBENS-2157

In Vivo Approaches to Investigate the Immune Response of Plant -Based Antitumour Drug, *Elephantopus Scaber* L.

Balakrishnan Sreedevi Geetha | *Kerala State Council For Science, Technology and Environment*

Latha Panickamparambil Gopalakrishnan | *Jawaharlal Nehru Tropical Botanic Garden and Research Institute*

Mangalam Sivasankaran Nair | *National Institute for Interdisciplinary Science and Technology*

GCBENS-2158

Comparison of Growth Medium Efficiency into Lady's Finger (*Musa Acuminata*, AA) Shoot Biomass in Thin-Layer System, TIS RITA[®] Bioreactor, and Bubble Column Bioreactor

Michael Setiadi Tanera | *Institut Teknologi Bandung*

Ahmad Faizal | *Institut Teknologi Bandung*

Rizkita Rachmi Esyanti | *Institut Teknologi Bandung*

GCBENS-2164

The Efficiency of Growth Medium Bioconversion into Banana (*Musa acuminata*, AA) Plantlet Biomass in Temporary Immersion System (TIS) RITA[®] Bioreactor with Different Immersion Periods

Hans Indra Pramana | *Institut Teknologi Bandung*

Ahmad Faizal | *Institut Teknologi Bandung*

Rizkita Rachmi Esyanti | *Institut Teknologi Bandung*

GCBENS-2165

Fast, Reliable and Simultaneous Determination of Theobromine and Caffeine in Fermented and Unfermented Cacao Beans and in Cocoa Products Using Reverse Phase HPLC

Ian Marc Gealon Cabugsa | *Ateneo de Davao University*

Kim Ryan Alcantara Won | *Ateneo de Davao University*

GCBENS-2179

The Anti-Inflammatory Activity of Ginsenoside Rg3-Enriched Red Ginseng Extract in Vitro and in Vivo

Man Hee Rhee | *Kyungpook National University*

GCBENS-2183

The Effect of Manggong Bamboo Leaves Extract (*Gigantochloa Manggong*) on Rat (*Rattus Novergicus*) Blood Profile

Sri - Rahayu | *State University of Jakarta*

Supriyatin | *State University of Jakarta*

Yuli - Rahmadini | *State University of Jakarta*

Management (1)

Friday, February 19, 2016 14:45-16:15 Orchid Room

Session Chair: *Prof. Rikiya Tsuchihashi*

APSSSM-1401

Repurchase Intention between Commitment and Patient Trust

Sedianingsih | *Universitas Airlangga*

Imron Mawardi | *Universitas Airlangga*

Ari Prasetyo | *Universitas Airlangga*

APSSSM-1402

Excellent Service Based on the Concept of Corporate Entrepreneurship in Hospital

Ririn Tri Ratnasari | *Universitas Airlangga*

Masmira Kurniawati | *Universitas Airlangga*

APSSSM-1429

Incumbent Firms' Success in Adopting Radical Innovation: Case of Olympus Corporation, Japan

Rikiya Tsuchihashi | *Nagasaki University*

Yuichi Goto | *Nagasaki University*

ICEASS-1903

Urban Transportation Services and Accessibility: A Case Study of RMUTT Campus, Thailand

Nawhath Thanvisitthpon | *Rajamangala University of Technology Thanyaburi*

Economics (1)/Finance

Friday, February 19, 2016 16:30-18:00 Lilac Room

Session Chair: *Prof. Yang-Kyu Shin*

ICEASS-1719

Gender Diversity's Board Structures, Ownership Structure and Corporate Performance in Indonesian Companies

Wisnu Setiyono | *Muhammadiyah University of Sidoarjo*

Desy Irawaty | *Muhammadiyah University of Sidoarjo*

ICEASS-1774

Analysis of CSR Impact Program in Enhancing Beneficiaries Welfare(A Case Study of Catfish Cultivation Group Tanah Berongga-Sido Urep Kebun Tanjung Seumantoh Village, Karang Baru Sub District Aceh Tamiang District, Aceh Province)

Baihaqi Baihaqi | *University of Samudra*

Zulkarnen Mora | *University of Samudra*

Abdul Latief | *University of Samudra*

ICEASS-1817

Consumption Pattern and Marketing Practices of Selected Fruits in La Union

Victoria M. De Padua | *Don Mariano Marcos Memorial State University*

Venelyn L. Bersamira | *Don Mariano Marcos Memorial State University*

APSSSM-1361

Correlation between Institutional Investor Type and Financial Investor Behavior

Yang-Kyu Shin | *Daegu Haany University*

Chemical Engineering/ Fundamental and Applied Sciences/

Material Science and Engineering

Friday, February 19, 2016 16:30-18:00 Lotus Room

Session Chair: *Prof. Ur Ryong Cho*

TICEAS-1263

Rice Bran Carbon/Styrene Butadiene Rubber Composites with Excellent Mechanical, Thermal and Tribological Performances

Yinhang Zhang | *Korea University of Technology and Education*

Ur Ryong Cho | *Korea University of Technology and Education*

TICEAS-1277

Graft Chitosan onto Bamboo Charcoal Sulfonated Carbon-Based Solid Acid by Sulfonation Reaction to Reinforce Natural Rubber Latex

Xiangxu Li | *Korea University of Technology and Education*

Ur Ryong Cho | *Korea University of Technology and Education*

TICEAS-1289

RuCl₃ Catalyzed Oxidative Conversion of Aryloximes to Arylaldehydes: Kinetic, Mechanistic and Catalytic Chemistry

Puttaswamy | *Bangalore University*

A. S. Manjunatha | *Bangalore University*

TICEAS-1249

Some Properties of the (p,q) - Fibonacci Numbers and (p,q) - Lucas Numbers

Alongkot Suvarnamani | *Rajamangala University of Technology Thanyaburi*

Teerat Kasamwan | *Rajamangala University of Technology Thanyaburi*

TICEAS-1401

Preparation of Ni-Al₂O₃ Composite Plating by Electroless Plating

Hansam Kim | *Inha Technical College*

TICEAS-1290

Study on Synthesis of Thermal Conductive Adhesive Using Alumina Modified with Silane Coupling Agent as Filler

Ji Hwan Oh | *Korea University of Technology and Education*

Ur Ryong Cho | *Korea University of Technology and Education*

TICEAS-1430

Exploring Novel Macrocyclic Tin(II) Scaffolds for Drug Discovery: Synthesis, Biological Evaluation and Molecular Docking Studies

Ekta Rawat | *Kurukshetra University*

Ashu Chaudhary | *Kurukshetra University*

Culture/Psychology/Society (2)

Friday, February 19, 2016 16:30-18:00 Orchid Room

Session Chair: *Prof. Shu Hui Lin*

APSSSM-1375

Bernard Stiegler's Possibilities of Informational Space on William Gibson's All Tomorrow's Parties

Yi-Jhen Lee | *National Taiwan University*

APSSSM-1408

Exploring the Relationship between the Appearance Design and Personality Expression of the Personified Characters in Eastern and Western 2D Animated Film

Tsai Ping Chang | *Tatung University*

Pei-Jung Cheng | *Tatung University*

APSSSM-1411

A Study on the Relationship between the Personified Roles' Postures and the Interaction with the Main Character in Eastern and Western 2D Animated Movies

Nian-Jhen Cai | *Tatung University*

Tsai Ping Chang | *Tatung University*

Pei-Jung Cheng | *Tatung University*

APSSSM-1442

Observations on World Culture: Travel Writings of a Taiwanese Intellectual

Shu Hui Lin | *National Taiwan Normal University*

APSSSM-1460

Role Of Sources of Career Decision Making Self-Efficacy (Indonesian Version) in Developing Career Decision Making Self-Efficacy on Indonesian Young Adults

Rina Rahmatika | *YARSI University*

Fitri Arlinkasari | *YARSI University*

Sari Zakiah Akmal | *YARSI University*

APSSSM-1443

E-competency: Crossing the Bridge Towards Digital Extension in the Philippines

May Angelica Almoite Saludez | *Philippine Rice Research Institute*

Irene Roxas Tanzo | *Philippine Rice Research Institute*

ICEASS-1795

Lesson-Specific Measures, Self-Regulation, and Collective Teacher Efficacy and Their Impact on Students' Academic Performance: Basis for Enhancement Program

Annie S. Rafols | *DepEd Division Office Malolos*

Management (2)

Saturday, February 20, 2016

08:45-10:15

Lilac Room

Session Chair: *Prof. Irene Hau Siu Chow*

APSSSM-1385

Humorous Leadership and Employee Adaptability: An Affect-As-Information Theory Perspective

Irene Hau Siu Chow | *Hang Seng Management College*

Amy Chung Yee Wong | *Hang Seng Management College*

Mariana Lai Ling Chow | *Hang Seng Management College*

APSSSM-1389

The Impact of Coaching on Work Role Performances: The Indirect Effects of Specific Emotions and Self-efficacy

Ray Tak-yin Hui | *Hang Seng Management College*

APSSSM-1406

Exploring Cross-Cultural Sensitivity of Western Expatriate Managers in the Philippines

Beatriz Kaamiño-Tschoepke | *De La Salle University*

ICEASS-1854

Filipino Women in Cooperative Management

Victoria de Padua | *Don Mariano Marcos Memorial State University*

Hezel Dinangan | *Don Mariano Marcos Memorial State University*

Venelyn Bersamira | *Don Mariano Marcos Memorial State University*

ICEASS-1867

How Organization Design Elements Impact Innovation in the Pharmaceutical Industry of India

Yamini Prakash Sahay | *Indian Institute of Management (IIM) Rohtak*

Computing Science & IT Engineering

Saturday, February 20, 2016

08:45-10:15

Lotus Room

Session Chair: *Prof. Isara Nakavisute*

TICEAS-1260

New Integer Programming Models for Kidney Exchange Program

Junsang Yuh | *Korea University*

Taesu Cheong | *Korea University*

Soonkyo Lee | *Korea University*

Seokhyun Chung | *Korea University*

TICEAS-1291

A Study on Predictive Algorithm for Estimating the RUL of Offshore Plant Equipment

Yongjae Kim | *Hongik University*

Minyeong Seo | *Hongik University*

Hongbae Jun | *Hongik University*

Chunghun Ha | *Hongik University*

Jongho Shin | *Ulsan National Institute of Science and Technology*

TICEAS-1293

WAILU: Wireless Assisted Indoor Localization of User

Chesta Sofat | *PEC University of Technology*

Savina Singla | *PEC University of Technology*

Divya Bansal | *PEC University of Technology*

TICEAS-1400

Optimizing Internet Search Engine Time with Vector Space Model (VSM)

Isara Nakavisute | *Sripratum University*

Ajjima Montaphan | *Sripratum University*

Management (3) /Communication

Saturday, February 20, 2016 10:30-12:00 Lilac Room

Session Chair: *Prof. Indrianawati Usman*

APSSSM-1392

The Requirements for APP Design for Project Management Personnel

Xin Yu Liu | *Fu Jen Catholic University*

Li Hao Chen | *Fu Jen Catholic University*

APSSSM-1438

Hospital Image as a Moderating Variabel to the Effect of Hospital Service Quality to Customer Perceived Value, Customer Trust and Customer Loyalty of a Hospital Service in Surabaya-Indonesia

Indrianawati Usman | *Airlangga University*

APSSSM-1450

The Business Model of Trade eBooks from Consumer Viewpoint, a Conceptual Framework

Poh Swee Hiang | *University of Malaya*

Md Sidin Ahmad Ishak | *University of Malaya*

ICEASS-1871

Qualitative Analysis of Two Translation Training Courses in Japan and the United States

Masako Terui | *Kinki University*

Atsuko Misaki | *Kinki University*

Shoji Miyanaga | *Kinki University*

Judy Noguchi | *Kobe Gakuin University*

ICEASS-1862

Consumer Protection Awareness-Role of Education

P.Uma Maheswari Devi | *Adikavi Nannaya University*

B.Sankara Rao | *Adikavi Nannaya University*

ICEASS-1830

Tourist's Expectation and Satisfaction with the Inscribed World Heritage Site in the Philippines: With Special Reference to Kiangan, Ifugao

Michele Jaymalin-Dulay | *Ifugao State University*

Electrical & Electronic Engineering

Saturday, February 20, 2016 10:30-12:00 Lotus Room

Session Chair: *Prof. Seokho Yoon*

TICEAS-1310

A Novel Correlation Side-Peak Removal Technique for Unambiguous CBOC Signal Tracking

Keunhong Chae | *Sungkyunkwan University*

Seokho Yoon | *Sungkyunkwan University*

TICEAS-1316

The Mobile Robot Remote Control by Using Stereo Vision System

Chien-Wu Lan | *Chung Cheng Institute of Technology, National Defense University*

Hsiang-Yu Yang | *Chinese Culture University*

Shih-Sung Lin | *Chung Cheng Institute of Technology, National Defense University*

Kuang-Hsiung Tan | *Chung Cheng Institute of Technology, National Defense University*

Jo-Yen Nieh | *Chung Cheng Institute of Technology, National Defense University*

TICEAS-1376

Cuffless Estimation of Blood Pressure Using Photoplethysmographic Method

Yoshiki Tsuji | *Wakayama University*

Arata Suzuki | *Wakayama University*

TICEAS-1386

A Method for Deciding the PID Parameters for an Energy-Saving Design

Yusuke Inoue | *Wakayama University*

Arata Suzuki | *Wakayama University*

TICEAS-1387

Emotion Recognition by Using Features of Pulse Wave

Shunsuke Muraki | *Wakayama University*

Arata Suzuki | *Wakayama University*

TICEAS-1394

A Comparative Study of LPG-Modified Engine and Normal Oil-Usage Engine

Suphattharachai Chomphan | *Kasetsart University, Sriracha Campus*

Attaphon Chaimanatsakun | *Kasetsart University, Sriracha Campus*

Rattapol Sakornsinn | *Kasetsart University, Sriracha Campus*

Somboon Khumneungratavongsa | *Nakhon Phanom University*

Krit Rattanarat | *Nakhon Phanom University*

TICEAS-1429

Utilizaion of Refelecting and Refracting Properties of the Ionosphere Layer of Atmosphere for the Detection of Stealth Air Vehicles (SAV)

Muhammad Bin Tahir | *Alcatel-Lucent*

TICEAS-1272

An Accurate, Low-Cost Photovoltaic (PV) Evaluation-on-Chip (EoC) System by Combining MATLAB/Simulink and Microprocessor

Phuong Truong Le | *Da-Yeh University*

Huan-Liang Tsai | *Da-Yeh University*

Education (4)

Saturday, February 20, 2016 13:00-14:30 Lilac Room

Session Chair: *Prof. Simona Vasilache*

ICEASS-1712

Inclusive Education: Perception of Prospective Teachers – A Study

Vijaya Vardhini Sathuluri | *Dravidlan University*

ICEASS-1780

Student Perspectives of Computer Literacy Education in an International Environment

Simona Vasilache | *University of Tsukuba*

ICEASS-1715

Socialization and Perception of the Society by the Tribal Students and Their Academic Achievement: A Study

Ramesh Ghanta | *Maulana Azad National Urdu University*

ICEASS-1842

Value Orientation among Tribal Future Teachers of B.Ed. Programme: Need for Curricular Interventions

Rajendra Prasad Dasari | *Kakatiya University*

ICEASS-1754

Teacher Evaluation System Based on Graded Average Model of Student Feedback System for Higher Education Institutes in Sri Lanka

BPA Jayaweera | *Wayamba University of Sri Lanka*

DN Liyanage | *Wayamba University of Sri Lanka*

ICEASS-1812

Performance of On-The-Job Training of BSOAd Students

Rolyn A. Catamora | *Northwest Samar State University*

Mechanical Engineering

Saturday, February 20, 2016

13:00-14:30

Lotus Room

Session Chair: *Prof. Ryspek Usubamatov*

TICEAS-1355

Fundamental Basis of Gyroscope Theory

Ryspek Usubamatov | *University Malaysia Perlis*

TICEAS-1360

A Bounding Method for Contact Stress Based on Dinkelbach's Optimization Algorithm

Zhaocheng Xuan | *Tianjin University of Technology and Education*

Lixia Zhang | *Tianjin University of Technology and Education*

TICEAS-1388

Development of Compact Violin-Playing Robot

Sara Tsujimoto | *Wakayama University*

Arata Suzuki | *Wakayama University*

TICEAS-1389

Biomimetic Robot: Realization of the Mobility of Whirligig Beetle

Ryohei Tanaka | *Wakayama University*

Arata Suzuki | *Wakayama University*

Economics (2)

Saturday, February 20, 2016

14:45-16:15

Lilac Room

Session Chair: *Prof. Bo Yang*

APSSSM-1362

Growth, Instability and Structural Changes in Cashew Exports from India

Balakrishnan Muthusamy | *Tamil Nadu Agricultural University*

R. Thulasiram | *Tamil Nadu Agricultural University*

K. Chandran | *Tamil Nadu Agricultural University*

Balamurugan Veerasamy | *Tamil Nadu Agricultural University*

S. Arivarasan | *Tamil Nadu Agricultural University*

APSSSM-1363

Analysis of Growth, Instability and Market Integration of Coconut in India

Balamurugan Veerasamy | *Tamil Nadu Agricultural University*

K. Mani | *Tamil Nadu Agricultural University*

Balakrishnan Muthusamy | *Tamil Nadu Agricultural University*

T. Anitha | *Tamil Nadu Agricultural University*

S. Arivarasan | *Tamil Nadu Agricultural University*

APSSSM-1397

The Analysis of Nostalgia Element among the New Develop Rural-Urban Integration in Beijing

Shaoqing Tang | *Beijing Union University*

Ran Lu | *Beijing Union University*

Pengfei Jiang | *Beijing Union University*

APSSSM-1447

An Estimated DSGE Open-Economy Model of the Indian Economy with Financial Frictions

Vasco Gabriel | *University of Surrey*

Paul Levine | *University of Surrey*

Bo Yang | *University of Surrey & Xi'an*

ICEASS-1776

Trends and Issues of the Coffee Industry of Ifugao: An Empirical Analysis

Jennifer Madonna G. Dait | *Ifugao State University*

Civil Engineering (2)

Saturday, February 20, 2016

14:45-16:15

Lotus Room

Session Chair: *Prof. Tomohiro Nakano*

TICEAS-1309

The Study of the Beach Security Assessment Indicators in Taiwan

Chih-Chung Wen | *Hungkuang University*

Yong-Jun Lin | *National Taiwan University*

Tsung-Lin Lee | *China University of Science and Technology*

TICEAS-1311

Promotion of ICT Utilization by Electric Resistivity Management in Fluidization Treatment Process for Ground Improvement

Yasuhide Mochida | *Ritsumeikan University*

Indra Hardi | *Ritsumeikan University*

TICEAS-1315

A Feasibility Study on a Method for Prediction of Inner Part of Concrete Using Linier Traveltime Interpolation Method

Tomohiro Nakano | *Tokai University*

Hiromasa Kimita | *DaidoUniversity*

TICEAS-1332

Viscous Forces on a Circular Cylinder beneath Periodic Waves

Meng-Yu Lin | *Chung Yuan Christian University*

TICEAS-1351

A Comparative Study of Nonlinear Solution Techniques and Load Stepping Schemes for Critical State Soil Constitutive Models

Dipika Devi | *North Eastern Regional Institute of Science and Technology (NERIST)*

TICEAS-1269

A Combined Ground Penetrating Radar Analysis - Neural Network Methodology for Eroded Caves behind Seawall

Tsung-Lin Lee | *China University of Science and Technology*

Hung-Ming Lin | *National Cheng Kung University*

Chih-Chung Wen | *Hungkuang University*

Education (5)

Saturday, February 20, 2016 16:30-18:00 Lilac Room

Session Chair: *Prof. Remalyn Q. Casem*

ICEASS-1876

Effects of Flipped Instruction on the Performance and Attitude of High School Students in Mathematics IV

Remalyn Q. Casem | *Don Mariano Marcos Memorial State University*

ICEASS-1877

Bachelor of Elementary Education Program of Don Mariano Marcos Memorial State University Mid-La Union Campus: An Evaluation

Josephine E. Cacayan | *Don Mariano Marcos Memorial State University*

Arleen M. Olivares | *Don Mariano Marcos Memorial State University*

ICEASS-1878

Competence in Information Technology of the Faculty of the College of Technical Education

Aloysius J. Aurelio | *Don Mariano Marcos Memorial State University*

Noemi M. Boado | *Don Mariano Marcos Memorial State University*

Remalyn Q. Casem | *Don Mariano Marcos Memorial State University*

Myal A. Guba | *Don Mariano Marcos Memorial State University*

ICEASS-1879

Predictors of the National Achievement Test Performance of DMMMSU-MLUC High School Students

Noemi M. Boado | *Don Mariano Marcos Memorial State University*

Myal A. Guba | *Don Mariano Marcos Memorial State University*

Remalyn Q. Casem | *Don Mariano Marcos Memorial State University*

Primitiva M. Quevedo | *Don Mariano Marcos Memorial State University*

ICEASS-1880

Anxiety in Spoken English Language of the College of Technical Education Students

Josephine V. Gimpaya | *Don Mariano Marcos Memorial State University*

Riza Agustina A. Costales | *Don Mariano Marcos Memorial State University*

Avelina C. Visaya | *Don Mariano Marcos Memorial State University*

Alma M. Apilado | *Don Mariano Marcos Memorial State University*

Education (6)

Saturday, February 20, 2016

16:30-18:00

Lotus Room

Session Chair: *Prof. Henry Ma*

APSSSM-1480

University Learners' Preferred Materials and Their Image of Translation: Content Analysis of Open-Ended Responses

Kikuko Tanabe | *Kobe College*

APSSSM-1472

Influence of Intrinsic Motivation on Questioning Assumptions and Sensible Risks-Taking Behaviors in Engineering Education

Henry Ma | *The Hong Kong Polytechnic University*

ICEASS-1874

Prevalence and Prospects of an Interdisciplinary Prototype Sourcebook for Palawan Studies

John Christian S. Jardin | *Palawan State University*

ICEASS-1875

Building Paradigm of Dance Education in Palawan: The Sining Palawan Dance Troupe Experience

John Christian S. Jardin | *Palawan State University*

APSSSM-1486

Elements of Future News in Malaysia

Siti Suriani Othman | *Universiti Sains Islam Malaysia*

Liana Mat Nayan | *Universiti Tunku Abdul Rahman*

Lee Kuok Tiung | *Universiti Malaysia Sabah*

Nik Norma Nik Hassan | *Universiti Sains Malaysia*

Poster Session (1)

Biomedical Engineering/ Chemical Engineering/ Computing

Science & IT Engineering (1)

Friday, February 19, 2016

9:00-10:00

Pre-function Area

TICEAS-1374

Silver Nanoparticle Decorated Porous Reduced Graphene Oxide Composite as an Non-Enzymatic Glucose Sensor and Antibacterial Agent

Hoa Thuy Le | *University of Ulsan*

Yi Seul Song | *University of Ulsan*

Miri Seo | *University of Ulsan*

Seung Hyun Hur | *University of Ulsan*

TICEAS-1375

Low-Temperature NO₂ Gas Sensor Fabricated with NiO and Reduced Graphene Oxide Composite

Yen Linh Thi Ngo | *University of Ulsan*

Yi Seul Song | *University of Ulsan*

Miri Seo | *University of Ulsan*

Seung Hyun Hur | *University of Ulsan*

TICEAS-1393

Comparison with Reactivity of Oxygen Carriers Depending on the Various Additives

Chang Joon Park | *Yeungnam University*

Yeon Baek Seong | *Yeungnam University*

Tae Hoon Lee | *Yeungnam University*

Min Jung Kim | *Yeungnam University*

Won Young Choi | *Yeungnam University*

Jin Wook Lee | *Yeungnam University*

Tae Jin Lee | *Yeungnam University*

No-Kuk Park | *Yeungnam University*

TICEAS-1378

Evaluation of Long-Term Catalysts, Performance Regarding to Using FeCrAl Metal Foam in Diesel auto-Thermal Reaction

Chang Joon Park | *Yeungnam University*

Yeon Baek Seong | *Yeungnam University*

Tae Hoon Lee | *Yeungnam University*

Min Jung Kim | *Yeungnam University*

Won Young Choi | *Yeungnam University*

Jin Wook Lee | *Yeungnam University*

Tae Jin Lee | *Yeungnam University*

No-Kuk Park | *Yeungnam University*

GCBENS-2162

BCL3 siRNA Amphiphilic Dendriplexes for Effective and Potent Nasopharyngeal Carcinoma Treatment

Jing Ma | *University of Hong Kong*

Ling Peng | *Axi-Marseille University*

Siu Tim Cheung | *Chinese University of Hong Kong*

Kwok Wai Lo | *Chinese University of Hong Kong*

S. T. Wong | *University of Hong Kong*

GCBENS-2173

Graphene Oxide Enhances Grafting of Mesenchymal Stem Cells in Cell Therapy for Cardiac Repair

Jooyeon Park | *Seoul National University*

Bokyoung Kim | *Yonsei University Health System*

Han Young Kim | *Seoul National University*

Donghoon Choi | *Yonsei University Health System*

Byung-Soo Kim | *Seoul National University*

GCBENS-2174

Enhanced Expression of Angiogenic Growth Factors and Gap Junction Protein by Reduced Graphene Oxide for Cardiac Repair

Jooyeon Park | *Seoul National University*

Ju-Ro Lee | *Seoul National University*

Youngkeun Ahn | *Chonnam National University Hospital*

Seungmi Ryu | *Seoul National University*

Byung-Soo Kim | *Seoul National University*

Yong-Sook Kim | *Chonnam National University Hospital*

GCBENS-2177

pH-Sensitive Gold Nanoparticles Aggregation in hMSCs Enhances Tumor-Targeting Efficiency via NIR Photothermal Therapy

Byung-Soo Kim | *Seoul National University*

Seokyung Kang | *Seoul National University*

Jaesur Oh | *Seoul National University*

Suk Ho Bhang | *Sungkyunkwan University*

TICEAS-1380

One-Pot Synthesis of Nickel Titanate/Graphene Oxide for Visible-Driven Photocatalytic Degradation of Rhodamine B

Thanh-Truc Phama | *University of Ulsan*

Jiang Kaimingb | *University of Ulsan*

Eun Woo Shin | *University of Ulsan*

TICEAS-1417

Effect of Conductive Adhesive Layer on Anode Electrodes in Lithium Ion Batteries

Ji-Eun Lee | *University of Ulsan*

In-Yeong Choi | *University of Ulsan*

Jae-Hun Jeong | *University of Ulsan*

Eun-Suok Oh | *University of Ulsan*

TICEAS-1416

Cyanoethyl-Guar Gum Binders for $\text{Li}_4\text{Ti}_5\text{O}_{12}$ Negative Electrodes in Lithium-Ion Batteries

Inyeong Choi | *University of Ulsan*

Ji-Eun Lee | *University of Ulsan*

Eun-Suok Oh | *University of Ulsan*

TICEAS-1395

Vacuum-Free, All-Solution-Processable, Stretchable and Highly Sensitive Graphene-on-Polymer Strain Sensor for Bio-Signal Monitoring

Young Jin Park | *Sungkyunkwan University*

Jongwon Shim | *Amorepacific Co., Ltd*

Changhyun Pang | *Sungkyunkwan University*

Gi-ra Lee | *Sungkyunkwan University*

TICEAS-1396

Synthesis of a Water-Soluble Multi-Wall Carbon Nanotubes Functionalized with Sulfonated Polyaniline: Its Application to Binder in Lithium Ion Batteries

Jae-Hun Jeong | *University of Ulsan*

Eun-Suok Oh | *University of Ulsan*

TICEAS-1377

Keyword Foresight: Exploratory Text-Mining of Futuristic Big Data

Yongtae Park | *Seoul National University*

Jieun Kim | *Seoul National University*

Poster Session (2)

Material Science and Engineering/Mechanical Engineering

Friday, February 19, 2016

14:00-15:00

Pre-function Area

TICEAS-1207

Titanium Alloy Electrochemical Machining Process Parameters Optimization

Experiment Research

Qing-Bo Xiang | *Hefei University of Technology*

Yuan-Long Chen | *Hefei University of Technology*

Guang-Tao Jing | *Hefei University of Technology*

TICEAS-1234

Clothing Pressure Investigation Using Virtual Try-On Technologies

Kristina Ancutiene | *Kaunas University of Technology*

TICEAS-1246

The Influence of Laser Processing Applications for Leather Laminates Comfort

Ada Gulbinienė | *Kaunas University of Technology*

TICEAS-1251

Ag Nanoparticles Supported on GOs as Highly Efficient Catalysts for the Reduction of 4-Nitrophenol

Ji Dang Kim | *Chonnam National University*

Hyun Chul Choi | *Chonnam National University*

TICEAS-1254

Preparation of SnO₂ Nanoparticles and Investigation of Their Photocatalytic Properties for Methylene Blue

Sung Kyu Lee | *Chonnam National University*

Hyun Chul Choi | *Chonnam National University*

TICEAS-1284

Two-Phase Flow Analysis in the Flow-Injecting Nozzle of a Carbonating Tank

Haider Ali | *Kyungpook National University*

Kyung Won Kim | *Kyungpook National University*

Cheol Woo Park | *Kyungpook National University*

TICEAS-1397

A Numerical Investigation of Effect of Impact Flange on the Measurement Accuracy of Split Hopkinson Tensile Bar System

Khac-Ha Nguyen | *Seoul National University of Science and Technology*

Jong-Bong Kim | *Seoul National University of Science and Technology*

TICEAS-1319

Fabrication of the Nickel Nanostructured Surface by Using a NaCl-Containing Electrodeposition Solution

Jae Min Lee | *Pusan National University*

Young Jung | *Pusan National University*

Chang Jun Choi | *Pusan National University*

Jae Woo Jeong | *Pusan National University*

Jong Soo Koa | *Pusan National University*

TICEAS-1278

Flexible Thermoelectric Generator Based on PDMS

Kyung Kuk Jung | *Pusan National University*

Young Jung | *Pusan National University*

Chang Jun Choi | *Pusan National University*

Jong Soo Ko | *Pusan National University*

TICEAS-1320

The Synthesis of Various Shaped Silver Nanoparticles under Green Chemical Processing

Seong Soo Park | *Pukyong National University*

Gun-Dae Lee | *Pukyong National University*

Ashish A. Rokade | *Pukyong National University*

TICEAS-1324**Ultrasonic Atomization by Difference between Vibration Displacements of Two Circular Vibrating Plates**

Takuya Asami | *Nihon University*

Ryo Yakou | *Nihon University*

Takashi Ono | *Nihon University*

Hikaru Miura | *Nihon University*

TICEAS-1337**Thermal Degradation Behavior of Liquid Crystalline Epoxy Composites with Fumed Silica**

Bong Soo Lee | *Konkuk University*

Sang Hun Shin | *Konkuk University*

Seung Hyun Cho | *Soongsil University*

TICEAS-1404**Analysis on Mechanical Properties of Rebound Bumper Using Thermoplastic Elastomer with Optimization Method**

Kwang-Hee Lee | *Inha University*

Chul-Hee Lee | *Inha University*

TICEAS-1424**Preparation of Anthocyanin-Sensitized Amorphous TiO₂ Photocatalysts and Theirs Photocatalytic Properties under Visible Light Irradiation**

Jariyaporn Sangkaworn | *Silpakorn University*

Cheewita Suwanchawalit | *Silpakorn University*

Kritapas Laohhasurayotin | *National Nanotechnology Center (NANOTEC)*

TICEAS-1425**Synthesis of NiAl-Layered Double Hydroxide Film on Aluminium Foil**

Waranya Limprasart | *Silpakorn University*

Cheewita Suwanchawalit | *Silpakorn University*

Kritapas Laohhasurayotin | *National Nanotechnology Center (NANOTEC)*

Poster Session (3)

Education(1)/Law/Management/Psychology

Friday, February 19, 2016

15:30-16:30

Pre-function Area

APSSSM-1426

Parental Support as Perceived by Taiwanese University Students during Career Development

Ching-Hua Mao | *Chihlee University of Technology*

APSSSM-1458

The Relationship between Job Satisfaction and Intention to Stay in International Tourist Hotels

Hsiao-Ching Yang | *National Kaohsiung University of Hospitality and Tourism*

Wu-Chung Wu | *National Kaohsiung University of Hospitality and Tourism*

APSSSM-1459

E-Residency of Estonia Changes the Company Law System?

Masahiro Shimizu | *Chuo Gakuin University*

ICEASS-1777

The Perceived Influence of Career Barriers on Career Decision-Making Self-Efficacy by Adolescents with Disabilities in Transition Period

Hyegyeong Lim | *Pusan National University*

Jaekook Park | *Pusan National University*

ICEASS-1778

The Difference of Teacher Efficacy and Teaching Performance According to Teaching Experience of Elementary Special Teachers

Sunghwa Son | *Pusan National University*

ICEASS-1779

The Discrepancy between Elementary Science Teachers' Perceived Needs and Actual Implementation in Instructional Adaptations for Students with Disabilities

Yeonjae Lee | *Pusan National University*

ICEASS-1843

Canadian Raising: By Use of Variable Rules

Sha Liu | *Fukuoka University*

ICEASS-1863

Test Accommodations for Persons with Disabilities: On the National Examinations for Licensure and Certification in Korea

Jakyoung Kim | *Pusan National University*

Bohee Shin | *Pusan National University*

ICEASS-1870

“Mathematics is a Very Worthwhile Subject”: 9th Grade Students’ Attitudes and Beliefs about Mathematics

Junjira Pengkluab | *Chiang Mai University*

Duanghathai Katwibun | *Chiang Mai University*

APSSSM-1464

Consumers’ Brand Image of Shaoshing Wine

Lou-Hon Sun | *National Kaohsiung University of Hospitality and Tourism*

Jui-Chi Huang / *National Kaohsiung University of Hospitality and Tourism*

APSSSM-1476

The Traditional Bakery Industry Customer Satisfaction Research in Kaohsiung

Jung-Wei Lu | *National Kaohsiung University of Hospitality and Tourism*

Te-Png Kuo | *National Kaohsiung University of Hospitality and Tourism*

**Civil Engineering/ Environmental Engineering/ Natural
Sciences**

Saturday, February 20, 2016 9:00-10:00 Pre-function Area

TICEAS-1356

o-DGT as a Biomimic Surrogate for the Prediction of Bioavailability of PAHs in Contaminated Soils to *Pisum Sativum*

Hannah Oh | *Kyungpook National University*

Won Sik Shin | *Kyungpook National University*

TICEAS-1314

Effect of Thermal Conductivity of Insulating Block Made from Waste Limestone

Ah-Ram Ko | *Knagwon National University*

Woo-Keun Lee | *Knagwon National University*

TICEAS-1307

Investigating the Creep Behavior of the Air-Dried Mudstone in Southwest Taiwan

Hung-Ming Lin | *National Cheng Kung University*

Jian-Hong Wu | *National Cheng Kung University*

Jiun-Wei Yeh | *National Cheng Kung University*

Tsung-Lin Lee | *China University of Science and Technology*

TICEAS-1256

Effect of Chloride Ions on Electrical Resistivity in Concrete

In-Seok Yoon | *Induk University*

TICEAS-1257

Chloride Intrusion and Permeability of Concrete

In-Seok Yoon | *Induk University*

TICEAS-1406

Adsorption Equilibrium Characteristics of Lead Ions and Phenol on Chitosan-Bamboo Activated Carbon Bead

Tae Young Kim | *Chonnam National University*

Sung Young Cho | *Chonnam National University*

Jin Hwan Kim | *Chonnam National University*

TICEAS-1392

Development of a Field Geological Mapping System Prototype

Young Kwang Yeon | *Korea Geoscience and Mineral Resources*

You Hong Kihm | *Korea Geoscience and Mineral Resources*

GCBENS-2180

Phytoremediation of Radiocesium by Electrochemical Reducing Power Supply in Glasswort

Il Lae Jung | *Korea Atomic Energy Research Institute*

GCBENS-2189

Long-Term Adaptation Evolution of *Leuconostoc Mesenteroides* Subsp. *Mesenteroides* Strains

Pyung Cheon Lee | *Ajou University*

Si Yeon Ju | *Ajou University*

Soonhwan Oh | *Ajou University*

Hyun Jun Kang | *Ajou University*

Jin Won Kim | *Ajou University*

GCBENS-2190

Engineering of Synthetic Nar Promoter for the Expression of Metabolic Pathway Genes

Pyung Cheon Lee | *Ajou University*

Hee Jin Hwang | *Ajou University*

Jin Won Kim | *Ajou University*

GCBENS-2159

Antifungal Activity of Isolated Strains of *Streptomyces* and Their Multiple Mechanisms against Several Plant-Pathogenic Fungi

Hong-Gyu Song | *Kangwon National University*

Hae-Ryoung Kim | *Kangwon National University*

GCBENS-2170

Mechanistic Elucidation of Etoposide-Induced Cytotoxicity

Hyeon-Jun Shin | *Ajou University*

Hyuk-Kwon Kwon | *Ajou University*

Sangdun Choi | *Ajou University*

Computing Science & IT Engineering (2)/Electrical &

Electronic Engineering/ Fundamental and Applied Sciences

Saturday, February 20, 2016 14:00-15:00 Pre-function Area

TICEAS-1259

An Extraction of Respiration Component of Local Field Potential Signal

Shudao Zhou | *PLA University of Science and Technology*

Haotian Chang | *PLA University of Science and Technology*

Min Wang | *PLA University of Science and Technology*

Zhongliang Ma | *PLA University of Science and Technology*

TICEAS-1357

A Complexity Improvement in AMR-WB Speech Codec

Cheng-Yu Yeh | *National Chin-Yi University of Technology*

Yi-Chen Huang | *National Chin-Yi University of Technology*

TICEAS-1281

Study of a DC-DC Step-Up Converter with High Voltage Gain

Lung-Sheng Yang | *Far East University*

Chia-Ching Lin | *Far East University*

TICEAS-1297

Temperature Dependence of Reliability for Magnetic Tunnel Junctions with a Thin MgO Dielectric Film and TCAD Modeling

Youngtaek Oh | *Hanyang University*

Chulmin Choi | *Hanyang University*

Junseop An | *Hanyang University*

Yunheub Song | *Hanyang University*

TICEAS-1345**CC/CV Charge of the Wireless Power Transfer System for Electric Vehicle Battery Charger**

Van-Binh Vu | *Soongsil University*

Duc-Hung Tran | *Soongsil University*

Tran Duong | *Soongsil University*

Pham-Van Long | *Soongsil University*

Woojin Choi | *Soongsil University*

TICEAS-1280**Magnetism as a Probe of the Origin of Memristive Switching in Oxide Semiconductors**

Antonio Ruotolo | *City University of Hong Kong*

TICEAS-1402**Digital Forensic for Website Attack on XYZ's Domain**

Marvin Chandra Wijaya | *Maranatha Christian University*

TICEAS-1390**A Flying-Adder Frequency Synthesizer for FPGA-Based Applications**

Pao-Lung Chen | *National Kaohsiung First University of Science and Technology*

Chih-Hsuan Chang | *National Kaohsiung First University of Science and Technology*

TICEAS-1373**Relative Humidity Sensor Fabrication with PEDOT: PSS-PVA Composite on Piezoelectric Substrate Using SAW-EHDA Hybrid Thin Film Deposition**

Sajid Memoon | *Jeju National University*

Hyun Bum Kim | *Jeju National University*

Su Wan Kim | *Jeju National University*

Young Su Kim | *Jeju National University*

Hyo Tae Kim | *Jeju National University*

TICEAS-1270**Preparation of *Undaria Pinnatifida* Composite Films Containing Vanillin and Its Application**

Hyunju Yang | *Chungnam National University*

Kyung Bin Song | *Chungnam National University*

TICEAS-1298

**Error Estimation in Determining Parameters of Overlapping Peaks in Instrumental
Physical-Chemical Analysis**

Joseph Dubrovkin | *The Western Galilee College*

Education(2)/ Economics

Saturday, February 20, 2016 15:30-16:30 Pre-function Area

APSSSM-1390

Evaluation of Educational Attempt of Reverse Engineering on Electrical Engineering Class

Koichi Kurita | *Kinki University*

APSSSM-1417

Reciprocal Longitudinal Relationship between Career Maturity and Career Indecision of South Korean College Students

JuSung Jun | *Soongsil University*

Soyoung Kim | *Korea National Sport University*

APSSSM-1412

The Effect of Smartphone use on Emotional Problems in Adolescent

Soyoung Kim | *Korea National Sport University*

APSSSM-1446

The Research on Instructional Design and Assessment for the Interactive Learning System of Accounting Course

Yu-Fen Chen | *Chihlee University of Technology*

APSSSM-1456

The Research on Instructional Design and Assess for the Learning System of New Refrigerant

Huai-En Mo | *National Taiwan Normal University*

ICEASS-1685

Evaluating Chinese Handwriting Skills among Upper Kindergarten Children in Hong Kong

Linda F. L. Tse | *The Hong Kong Polytechnic University*

Cecilia W. P. Li-Tsang | *The Hong Kong Polytechnic University*

ICEASS-1775

The Effects of Language Intervention on Life Satisfaction and Quality of Communication Life of Adults with Cerebral Palsy

Gyeong Hee Jeong | *Pusan National University*

Sung Woo Ahn | *Pusan National University*

Chang Suk Shin | *Pusan National University*

ICEASS-1794

Teachers Questioning in Promoting 4th Grade Students Analytical Thinking in a Mathematics Classroom

Boontarika Sonti | *Chiang Mai University*

Duanghathai Katwibun | *Chiang Mai University*

ICEASS-1901

Sustainable Potato Production in the Philippine Cordillera Region

Ines C. Gonzales | *Benguet State University*

Cynthia G. Kiswa | *Benguet State University*

Arlene B. Bautista | *Benguet State University*

ICEASS-1894

The Relationship between Psychological Factors and the Meaning of Education in Students of Guilan University of Medical Sciences

Mahdokht Taheri | *Guilan University of Medical Sciences*

Ataoullah Asadi Louyeh | *Guilan University of Medical Sciences*

Sedigheh Pakseresht | *Guilan University of Medical Sciences*

ICEASS-1918

Analysis on Facilitators of Lifelong Education Participation of Students with Disabilities after Graduation Using Focus Group Interview

Soonyoung Hwang | *Pusan National University*

Hoohee Lee | *Pusan National University*





